

# T.28S. R.4W. W.M.

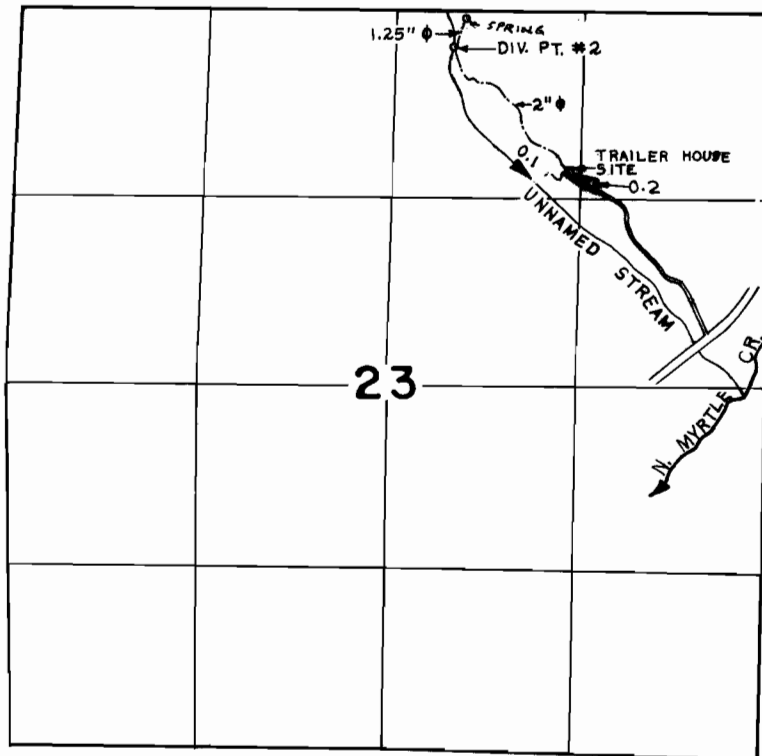

DIV. PT. #2 1,070' N. & 2,160' W. FROM N. 1/16 CORNER SECTIONS 23 & 24

SCALE : 4" = 1 mile

## FINAL PROOF SURVEY UNDER

57076                      43058  
Application No. 58954... Permit No. 44580.....  
IN NAME OF

..... GUY D. HARDAGE JR. ....

Surveyed SEPT. 30, 1983., by CLARK.....