

scale 5.28 inches = 1 mile

T 16 S R 26 E Sec 13 SW 1/4 of SE 1/4

SEDGE II RESERVOIR

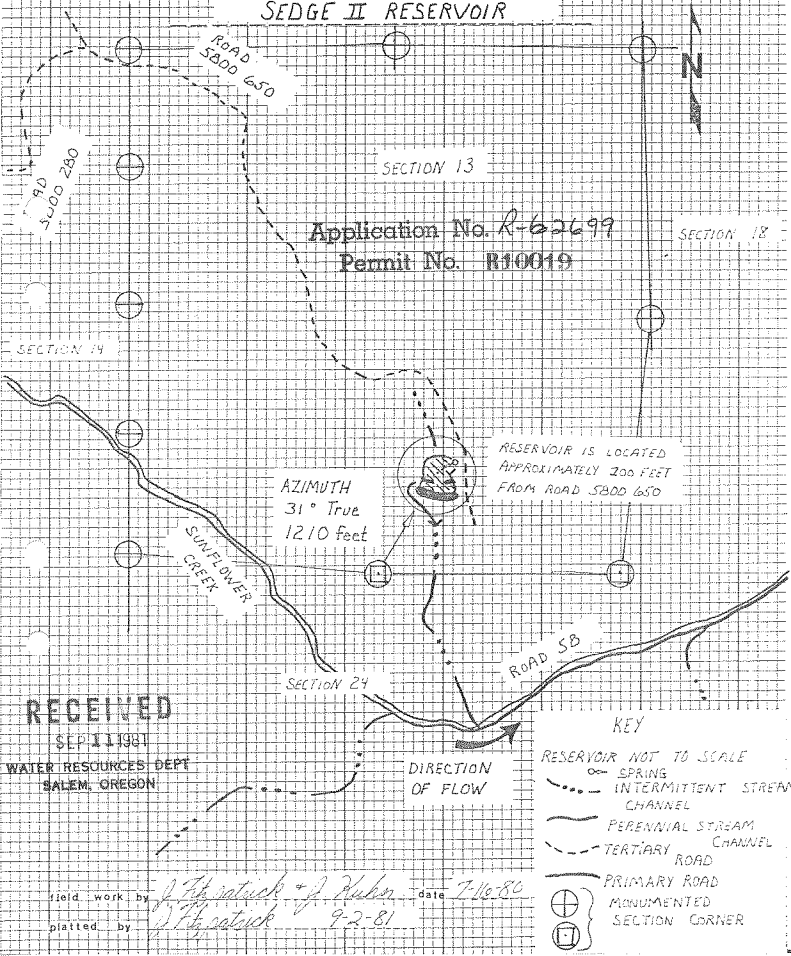

Application No. R-62699
Permit No. R10019

RESERVOIR IS LOCATED
APPROXIMATELY 200 FEET
FROM ROAD 5B00 650

AZIMUTH
31° True
1210 feet

SUNFLOWER
CREEK

ROAD 5B

RECEIVED

SEP 11 1981

WATER RESOURCES DEPT
SALEM, OREGON

KEY

- RESERVOIR NOT TO SCALE
- SPRING
- ⋯ INTERMITTENT STREAM CHANNEL
- PERENNIAL STREAM CHANNEL
- - - TERTIARY ROAD
- PRIMARY ROAD
- ⊕ MONUMENTED SECTION CORNER
- ⊙ SECTION CORNER

DIRECTION
OF FLOW

field work by

J. J. Ratuck + J. Huber

date

7-16-80

platted by

J. J. Ratuck 9-2-81