

T.5S., R.2W., W.M.

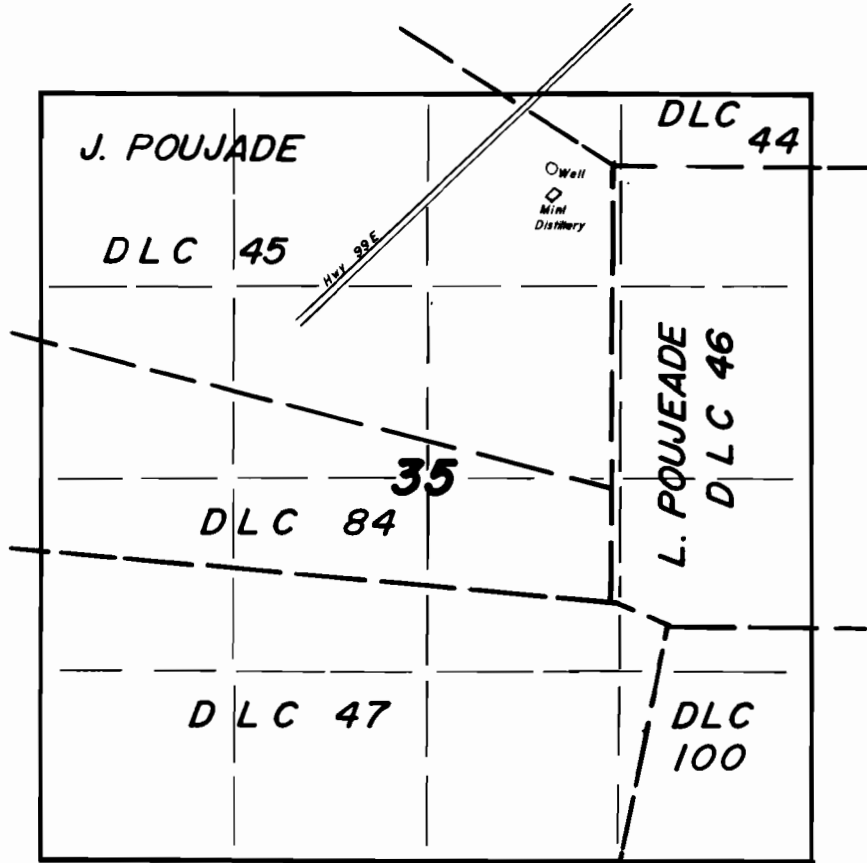

Well Loc.: 500' S. & 1780' W. from NE Cor. Sec. 35.

1" = 1320'

FINAL PROOF SURVEY

UNDER

Application No. G-9131... Permit No. G-8460...
IN NAME OF

JOHN T. WAVRA

Surveyed APRIL 16, 1984., by T. WARREN.....