

T. 27 & 28 S., R. 7 W., W.M.

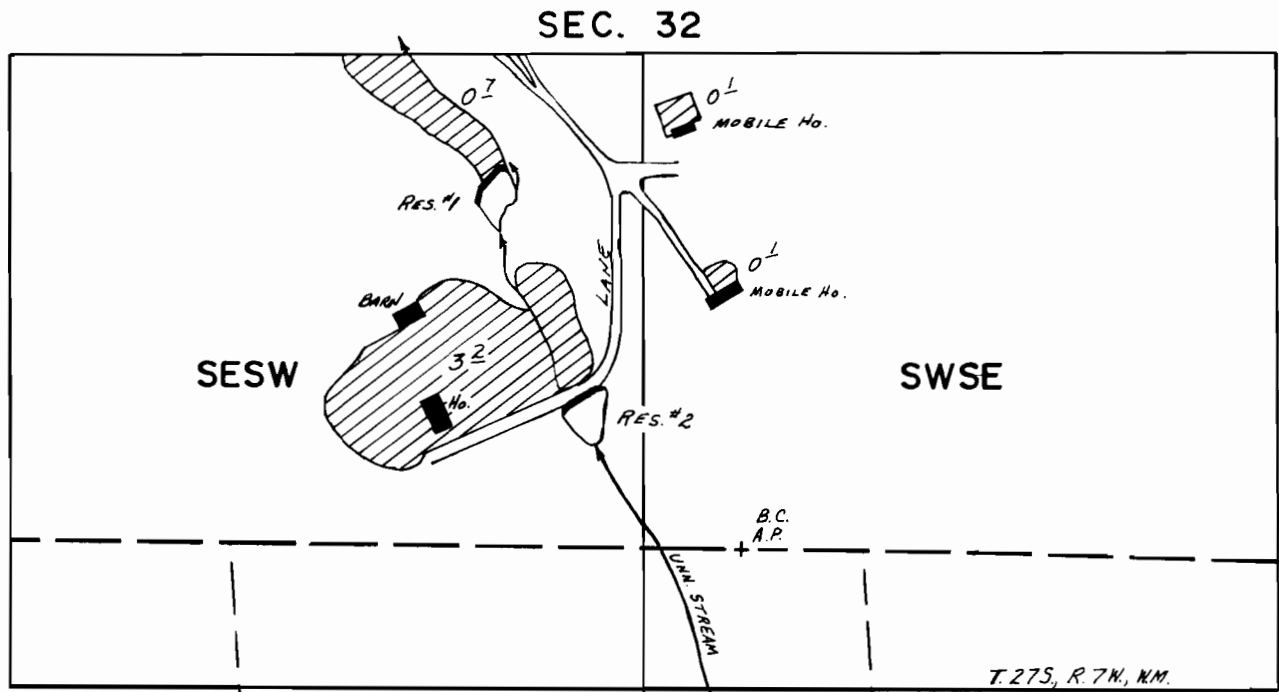

Lot 4 (NWNW)

SEC. 5

Lot 3 (NENW)

T. 27 S., R. 7 W., N.M.
T. 28 S., R. 7 W., W.M.

Lot 2 (NWNE)

Div. Pts. Loc.: RES #1 - 1070' N. & 320' W., RES. #2 - 600' N. & 130' W.,
Div. Pt. #3 - 70' S. & 160' E., ALL FROM S 1/4 COR.
SEC. 32.

SCALE: 1" = 400'

FINAL PROOF SURVEY
UNDER

R-57672 R-7738
Application No. 57673.. Permit No. 43680.....
IN NAME OF

MELVIN & ELLEN COWELL

Surveyed JUNE.22. 19.82. by L.M.TOLL.....