

T.7S., R.46E., W.M.

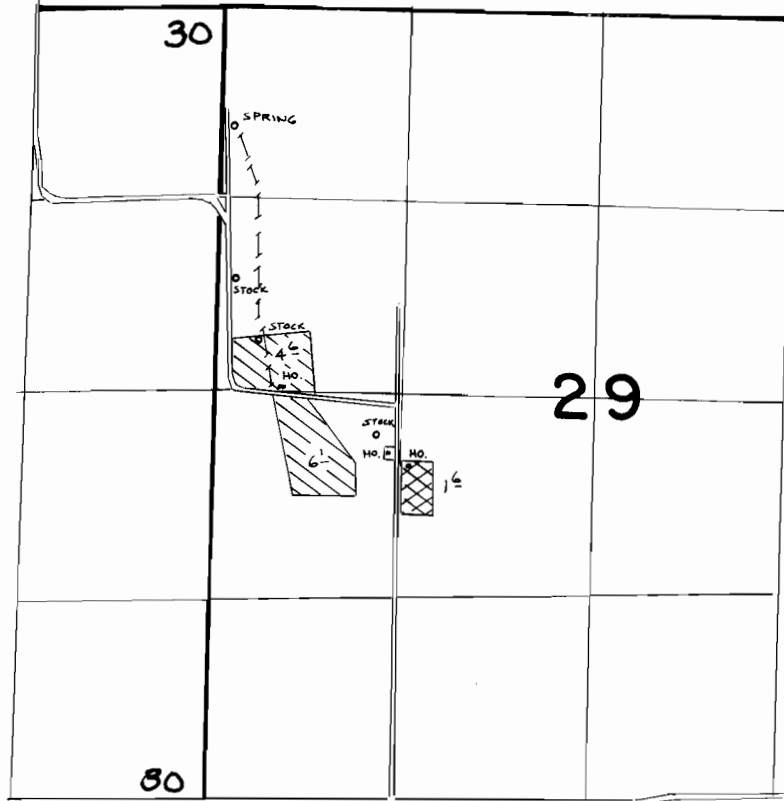

SPRING loc: 810' S. & 80' E. FROM NW COR SEC 29



PRIMARY



SUPPLEMENTAL

### FINAL PROOF SURVEY

UNDER

Application No. **55993** Permit No. **42208**...

IN NAME OF

**VERNON D. TYLER**

Surveyed *JULY 14* 19*82*, by *V. L. Church*