

T.7S., R.39E., W.M.

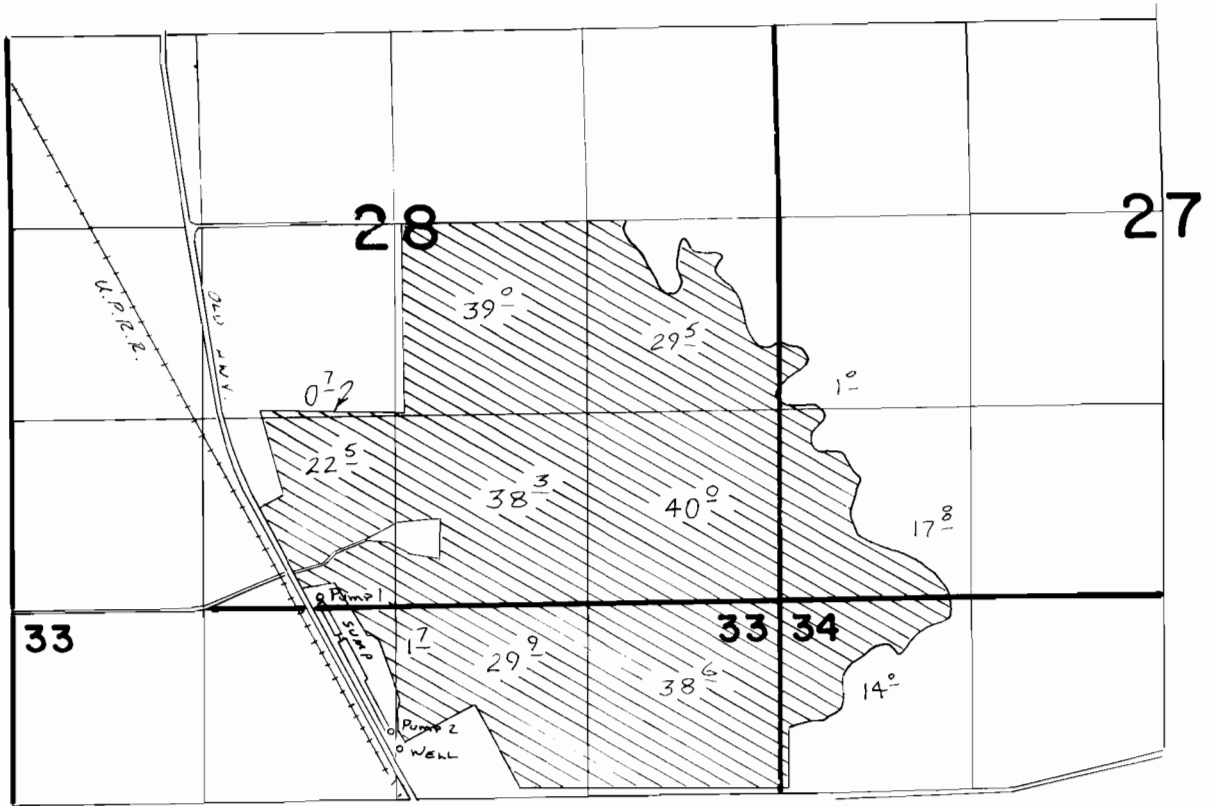

PUMP POINT 1 LOC: 80' N. & 510' W FROM S 1/4 COR. SEC 28
PUMP POINT 2 LOC: 850 S & 40' W FROM S 1/4 COR SEC 28

FINAL PROOF SURVEY
UNDER

Application No. **G:9028** Permit No. **G:8449**
IN NAME OF

HENRY STEELE

Surveyed July 5 1932, by J.H. Steele