

T.8S., R.39E., W.M. & T.9S., R.40E., W.M.

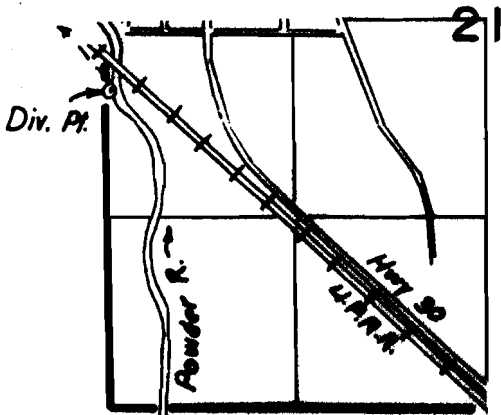

The location of the div. pt. is
 300' S. & 60' E. from W/4
 cor. sec. 21, T.9S., R.40E., W.M.

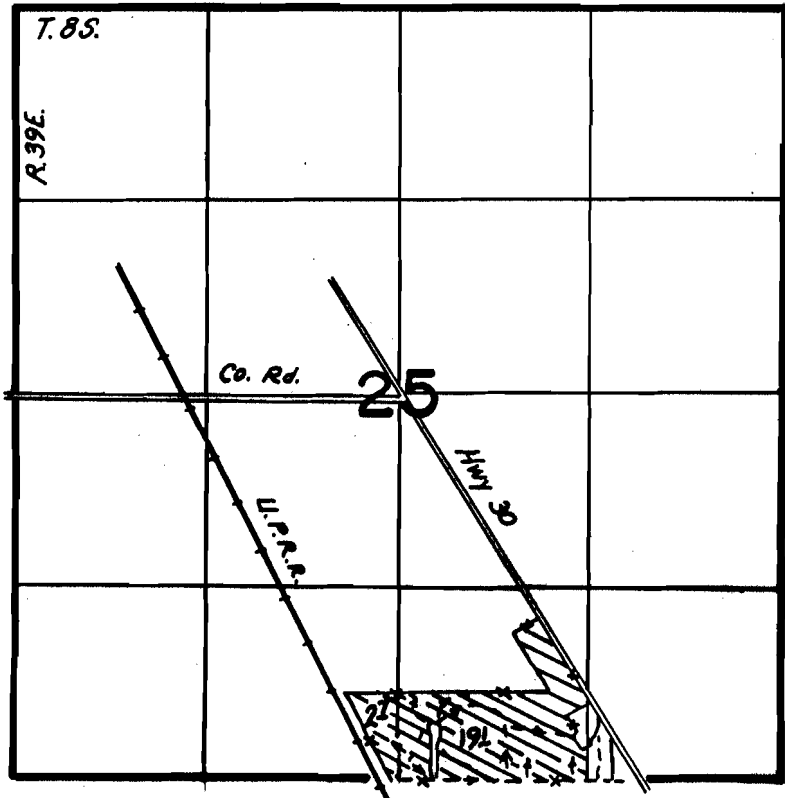

Scale: 1" = 1320'

FINAL PROOF SURVEY UNDER

Application No. 56855 Permit No. 42861
 IN NAME OF

FLOYD & MARGARET WHITSETT

Surveyed 8-1-1988, by Kern Kemp