

# T2N, R9&10W, WM

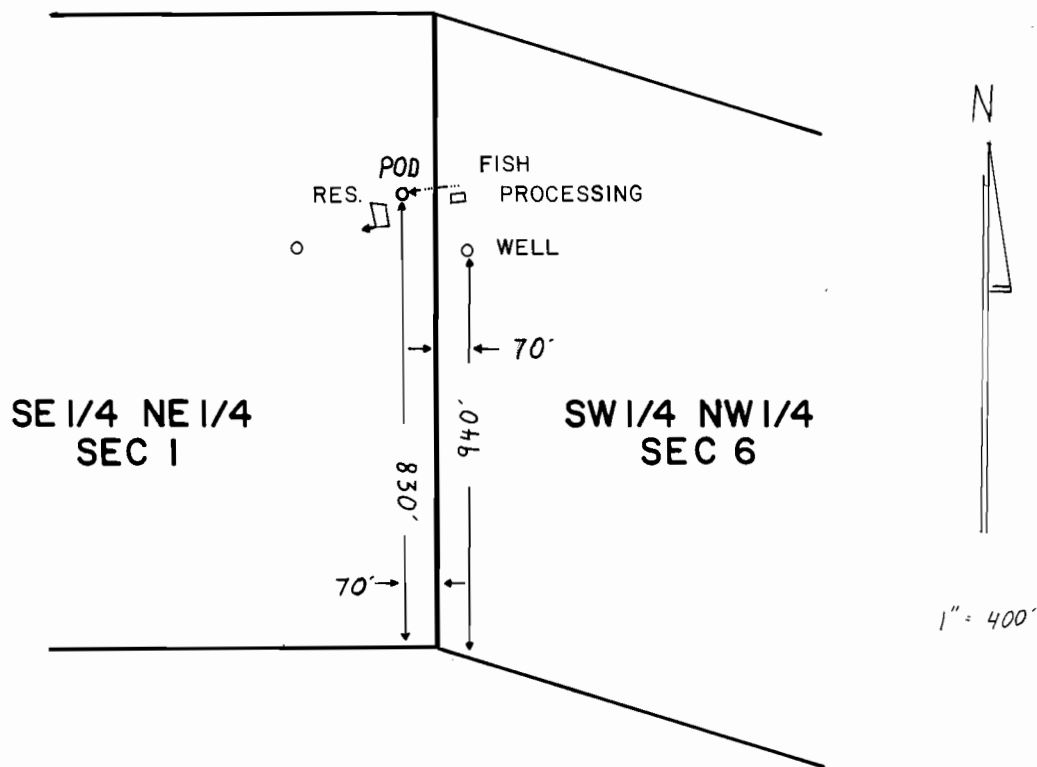

## FINAL PROOF SURVEY UNDER

G-9846                      G-9213  
 R-61788                    R-8299  
 Application No. 61789... Permit No. 45978.....

IN NAME OF

ROBERT L. & SHIRLEY M. MAI.....

Surveyed OCT. 1..... 1987., by T.M. WARREN.....