

T. 1 S., R. 3 W., W. M.

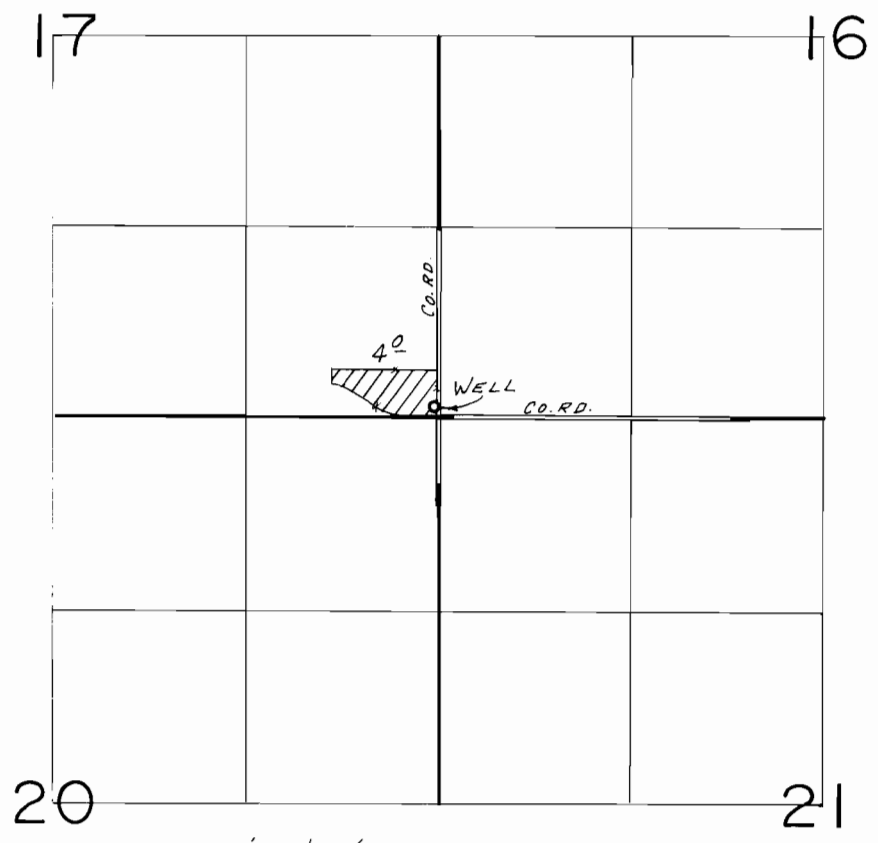

WELL LOC.: 70' N. & 40' W. FROM SEC COR. SEC. 17

SCALE: 1" = 1320'

FINAL PROOF SURVEY
UNDER

Application No. G-11109.. Permit No. G-10245...
IN NAME OF

DARRYL J. & DOROTHEA E. BLIVEN

Surveyed July 25... 19.86, by B.W. BISHOP.....