

T6S. R5W. WM.

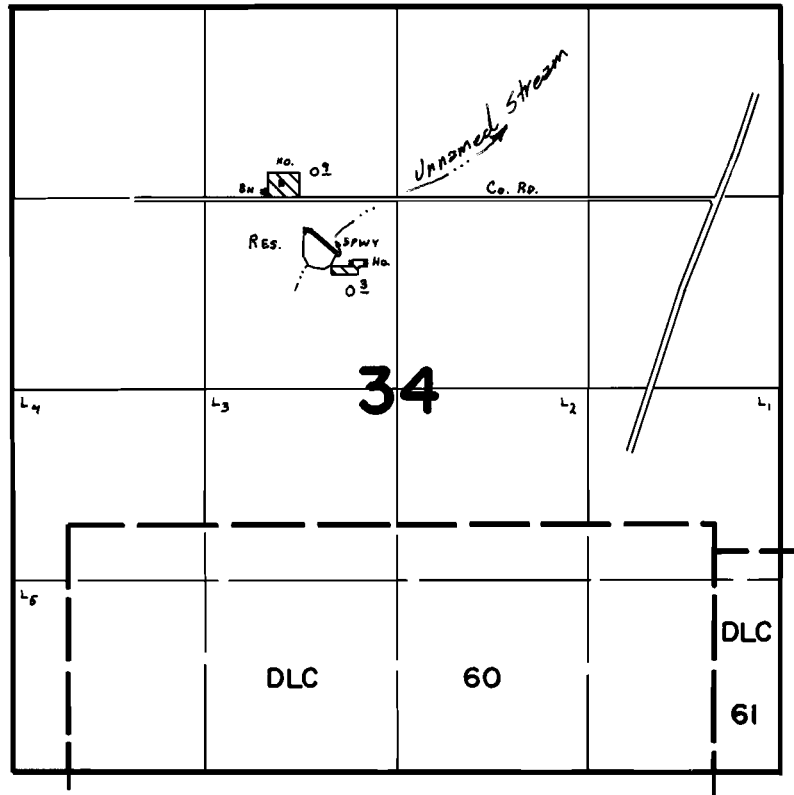

DAM Loc: 1600'S. & 500'W. FR. N. 1/4 COR. SEC. 34.

FINAL PROOF SURVEY UNDER

R-56957 R-6890
Application No. 56958 Permit No. 42773.....
IN NAME OF

.....ORPHA E. STAPLETON.....

Surveyed May 18, 1979, by C. L. HUGHES...