

T6S. R5W. WM.

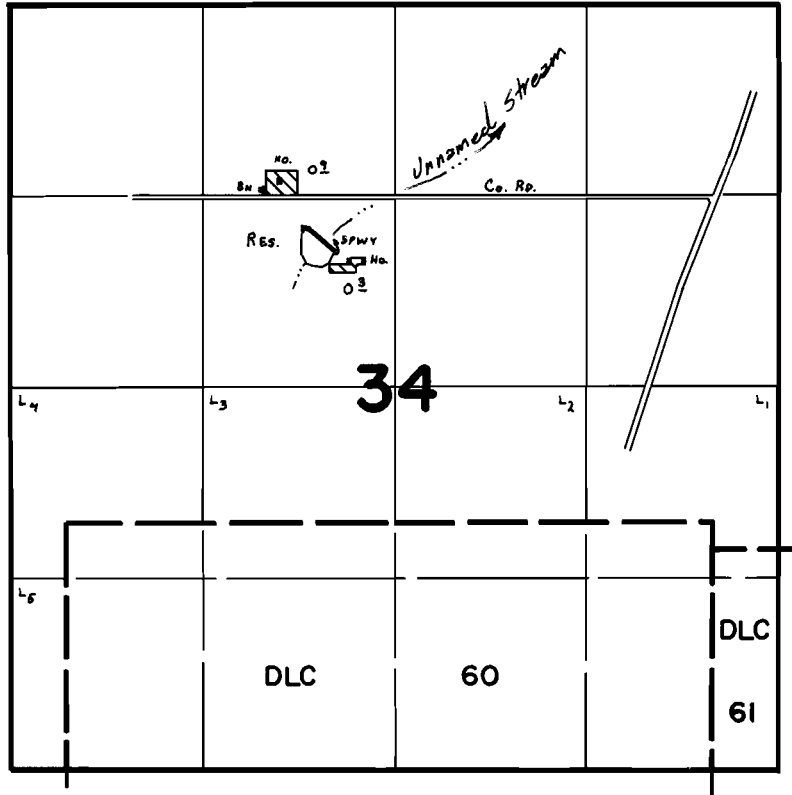

DAM Loc: 1600'S. & 500'W. FR. N. 1/4 COR. SEC. 34.

FINAL PROOF SURVEY UNDER

R-56957 R-6890
 Application No. 56958.. Permit No. 42773.....
 IN NAME OF

.....**ORPHA E. STAPLETON**.....

Surveyed May...18... 19.79, by .C...L...HUGHES...