

T.6S R.4W W.M.

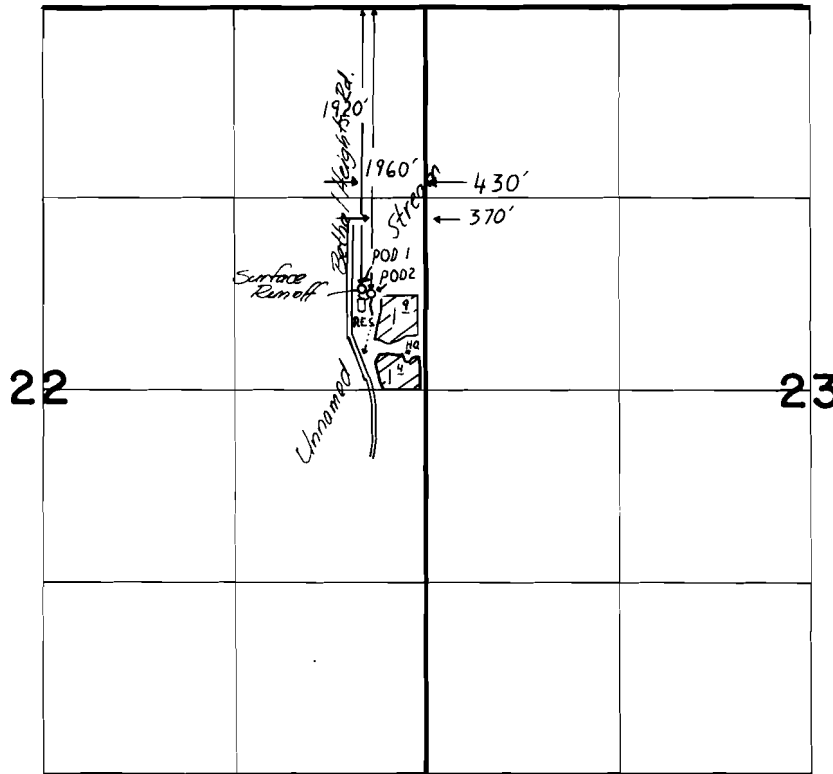

RES. LOC.: 2050' S. & 430' W. FROM NE CORNER SEC. 22

FINAL PROOF SURVEY UNDER

R-60498 R-8174
Application No. ~~60499~~ Permit No. 45039.....
IN NAME OF

.....MAX. HOLSTAD.....

Surveyed MAR. 22, 1988, by T.M. WARREN.....