

# T.6S R.4W W.M.

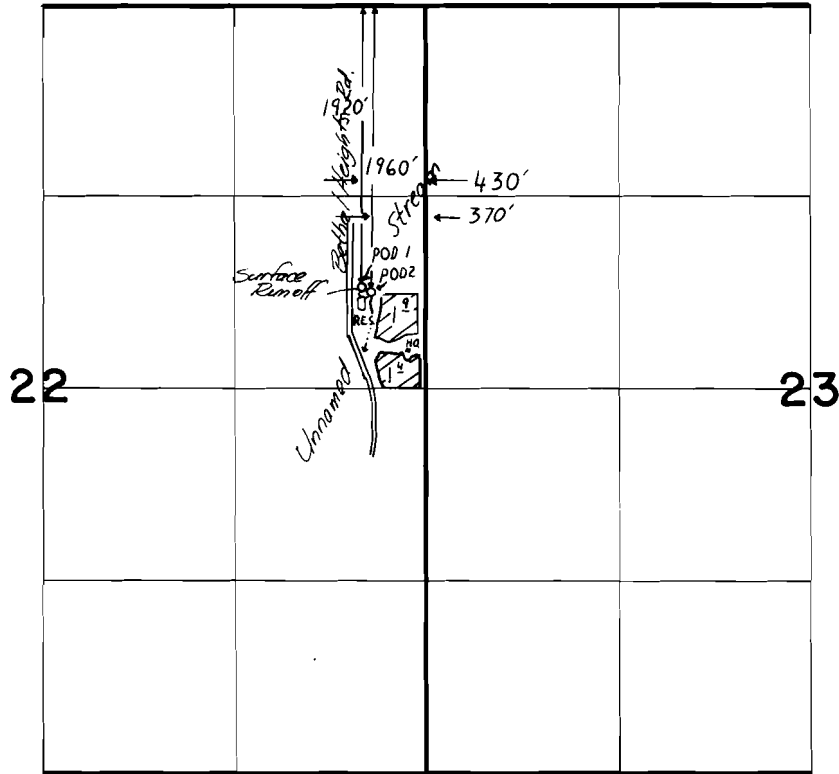

RES. LOC.: 2050' S. & 430' W. FROM NE CORNER SEC. 22

## FINAL PROOF SURVEY UNDER

R-60498                      R-8174  
Application No. ~~60499~~ Permit No. ~~45039~~.....  
IN NAME OF

.....MAX. HOLSTAD.....

Surveyed MAR. 22, 1988, by T.M. WARREN.....