

T.9S., R.15E., W.M.

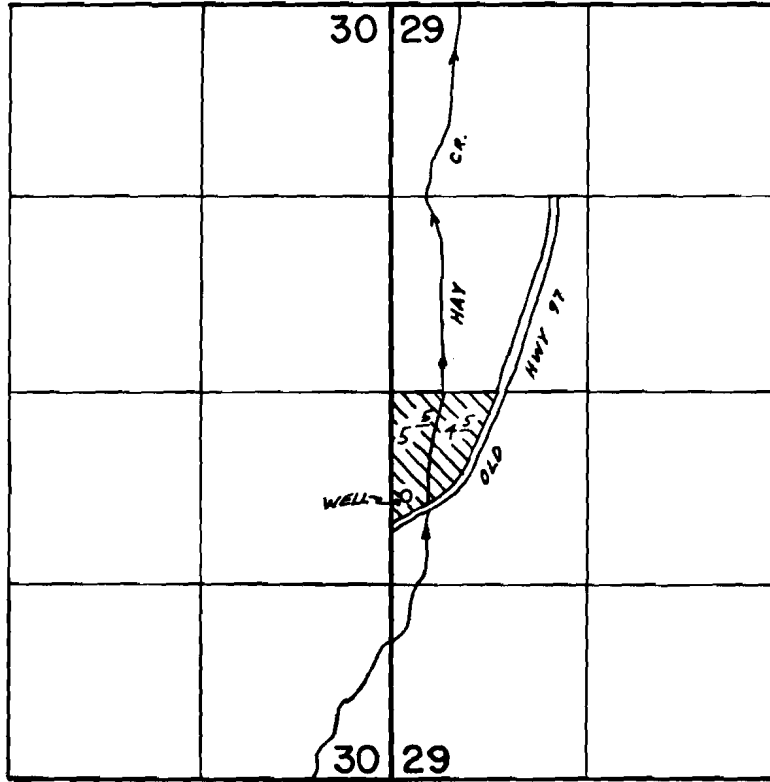

WELL LOC: 1900' N & 120' E OF THE S.W. COR., SEC. 29

SCALE: 1"=1320'

FINAL PROOF SURVEY UNDER

Application No. G-8930 Permit No. G-8322 Cert. # 160705
IN NAME OF

.....LESLIE E. & GINGER A. GANN.....

Surveyed AUG. 16 1988, by B. BISHOP.....

RECEIVED

DATE 5-23-89

WATER MASTER DISTRICT #11

BY JMS