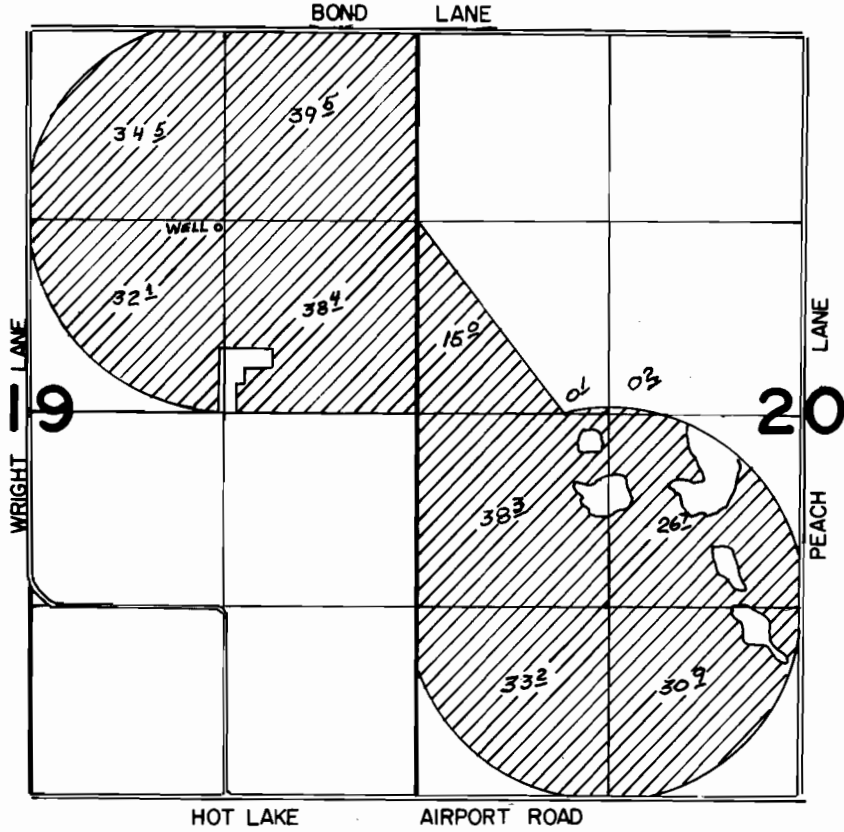

T. 3S. R. 39E. W.M.

SCALE: 1"=1320'

WELL LOCATED 1380' S. AND 1300' E. FROM N.1/4 COR. SEC. 19

FINAL PROOF SURVEY UNDER

Application No. G-9606... Permit No. G-8971.....
IN NAME OF

.....JOHN AND NANCY RAYBURN.....

Surveyed Aug. 5..... 1985., by X.L.CHURCH.....