

G10200  
60744

RECEIVED

MAR 15 1983

WATER RESOURCES DEPT.  
SALEM, OREGON

# T.4N., R.29E., W.M.

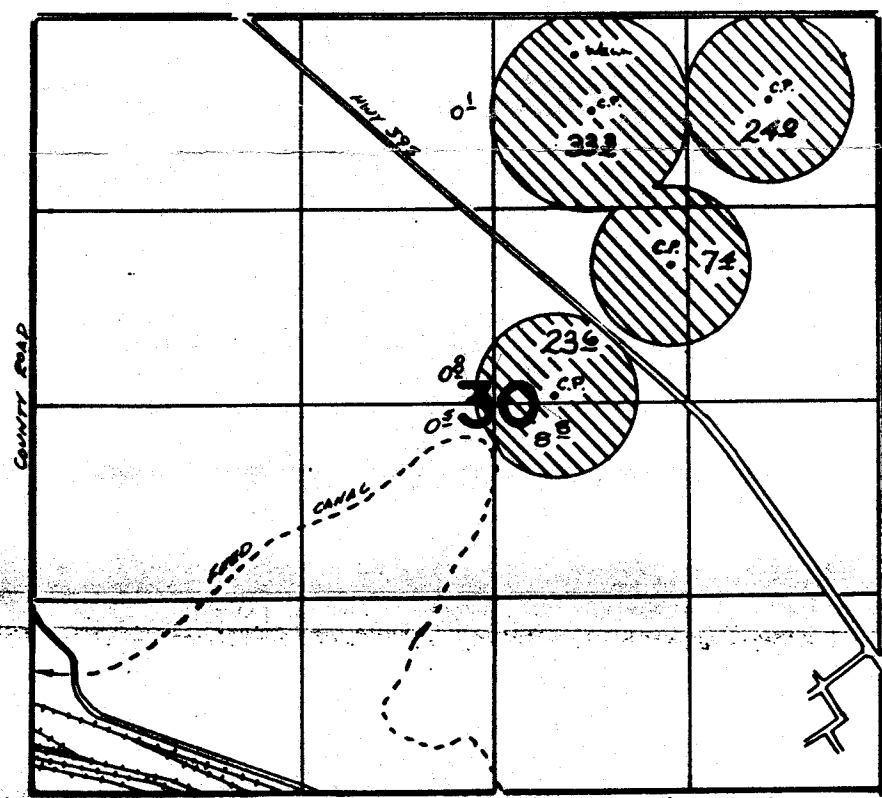

The location of the well is 260' S. & 2100' W.  
from the NE cor. sec. 30.

## FINAL PROOF SURVEY UNDER

Scale: 1" = 1320'

Application No. G10944; Permit No. G10200...  
IN NAME OF

.....KENNETH BATTY..... LEHMAN

Surveyed ...11-2... 1988, by ..Vera..Church...