

G 10652
60748

T. 2N., R. 32E., W. M.

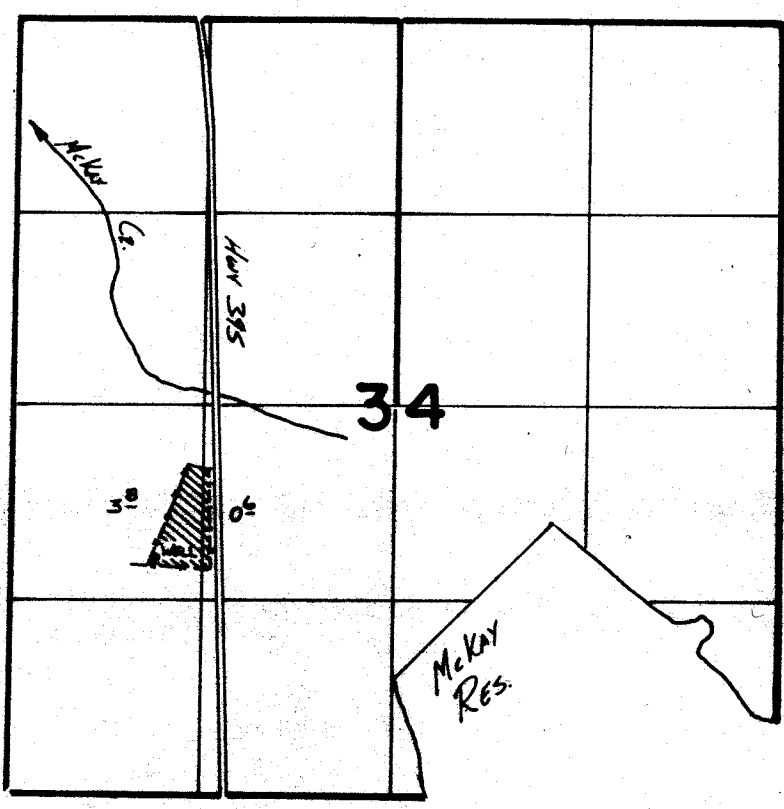

Well Loc: 1610' N. + 1000' E. FROM SW COR SEC. 34

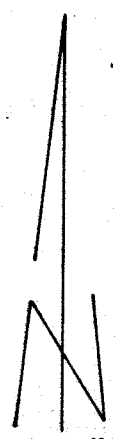

SCALE 1" = 1320'

FINAL PROOF SURVEY
UNDER

Application No. **G:11531** Permit No. **G:10652**
IN NAME OF

BRADLEY T. WHEELER

Surveyed 11-8 1988, by V.L. Church