

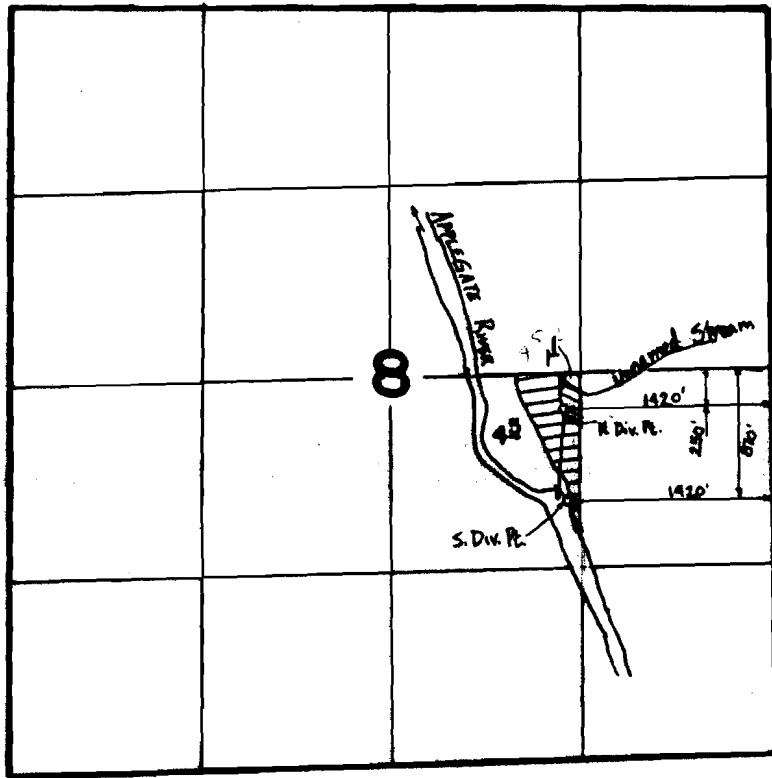

T.37S., R.6 W., W.M.



1420'
250'
675'

-  Primary from South Diversion Point (1)
-  Primary from North Diversion Point, Supplemental from South Div. Pt. (2)

FINAL PROOF SURVEY
UNDER

Application No. 56471.. Permit No. 42439....
IN NAME OF

.....**ROBERT P. STRAHAN**.....

Surveyed OCT. 18, 1983., by B.S. JAMES.....