

T. 5 S., R. 7 W. WM.

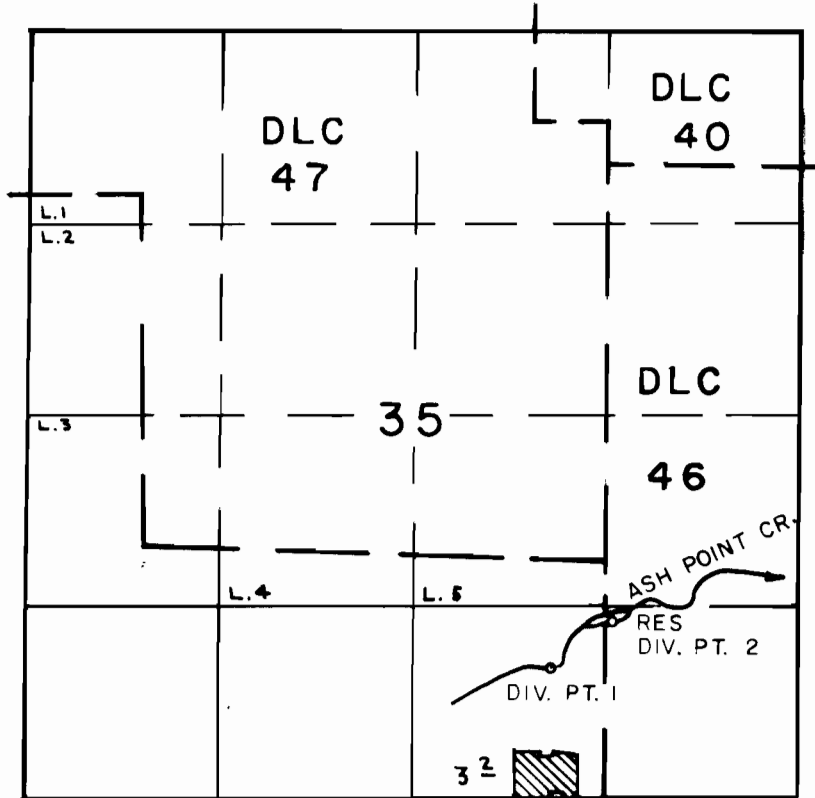

DIV. PT. LOC.: 1) 900' N. & 1690' W. OF SE COR. SEC. 35
2) 1130' N. & 1270' W. OF SE COR. SEC. 35

FINAL PROOF SURVEY UNDER

Application No. 57839 Permit No. 43574
IN NAME OF

IVAN DENT

Surveyed NOV. II. 1984, by P. PAGTER