

T.3S., R.2W., W.M.

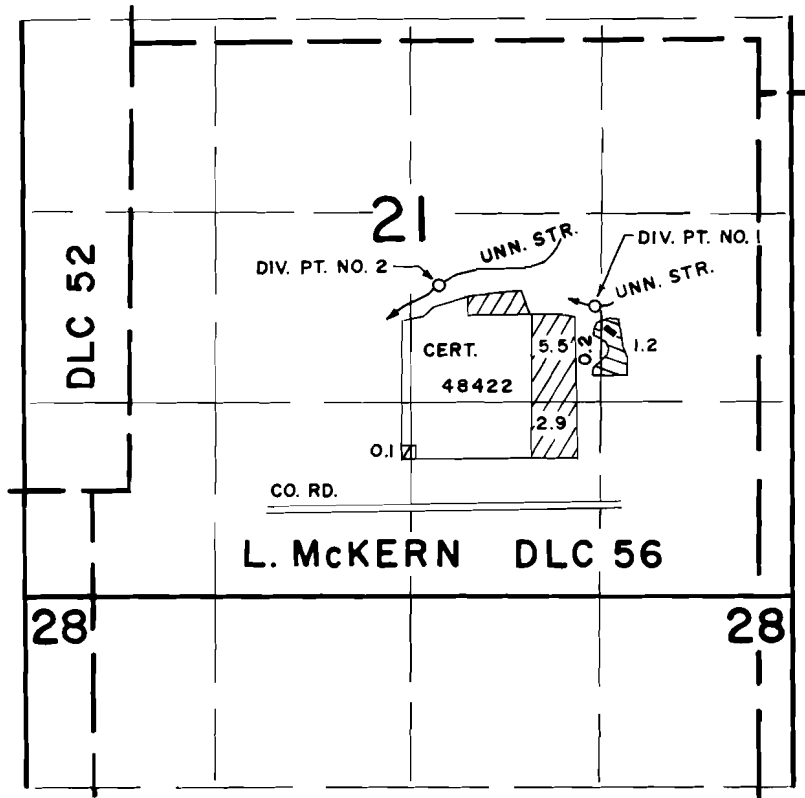

-  PERMIT 43247
-  PERMIT 44409

DIV. PT. NO. 1 LOC.: 2000 FT. N. AND 1260 FT. E.;
 DIV. PT. NO. 2 LOC.: 2140 FT. N. AND 180 FT. E.;
 BOTH FROM THE S. 1/4 CORNER OF SECTION 21.

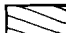
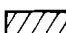

FINAL PROOF SURVEY UNDER

SCALE: 4" = 1 MILE

57384 43247
 Application No. 58941 Permit No. 44409....
 IN NAME OF

CRAIG EAGLESON

Surveyed NOV. 13, 1984, by *P. Patten*