

T.14S., R.15E., W.M.

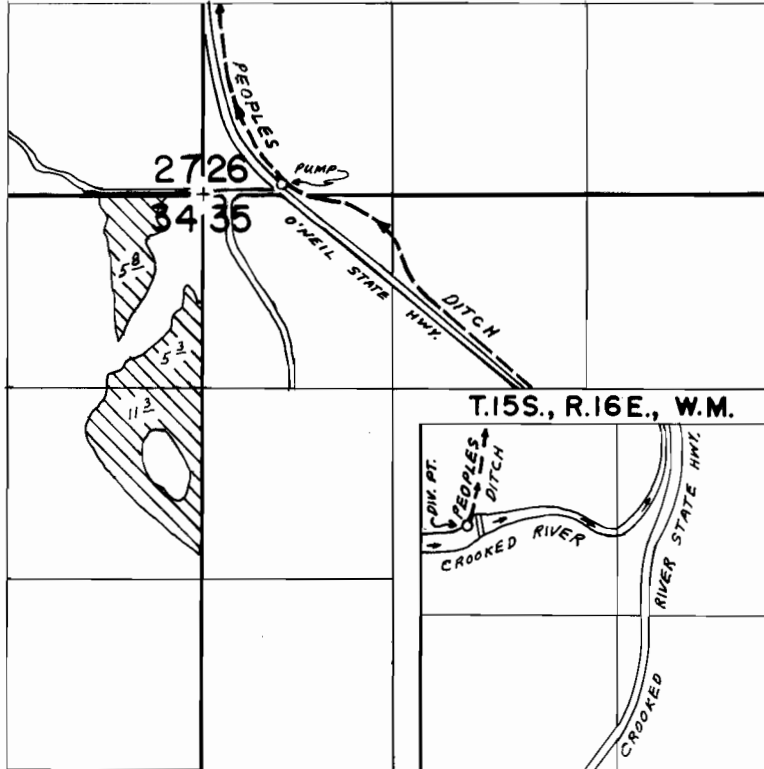

8

DAM LOC. 790'S & 410'E. From The W. 1/4 Cor. SEC. 8

SCALE: 1"=1320'

FINAL PROOF SURVEY
UNDER

Application No. 64846 Permit No. 47635

IN NAME OF

JOHN G. WANGLER

Surveyed SEPT. 28 1988, by B. BISHOP