

T.3S., R.2W., W.M.

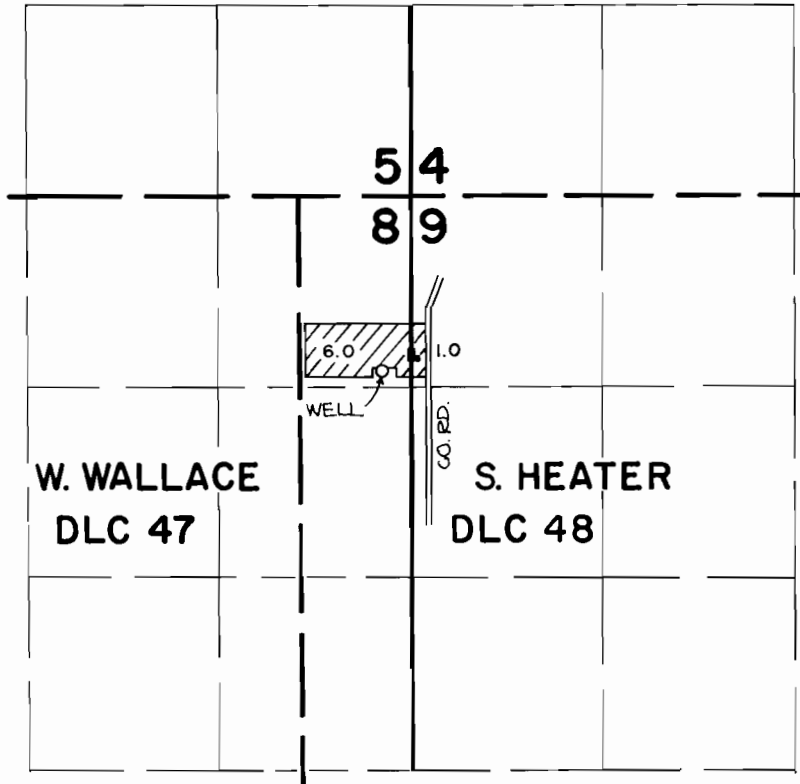

WELL LOCATION: 1210 FT. S. AND 210 FT. W. FROM THE N.E. CORNER OF SECTION 8.



FINAL PROOF SURVEY
UNDER

SCALE: 4" = 1 MILE

Application No. G-9332. Permit No. G-8828.....
IN NAME OF

ALLEN A. & CHERYL E. STEINKE

Surveyed NOV. 8, 1984, by *P. Paster*