

# T. 1 S., R. 4 E., W.M.

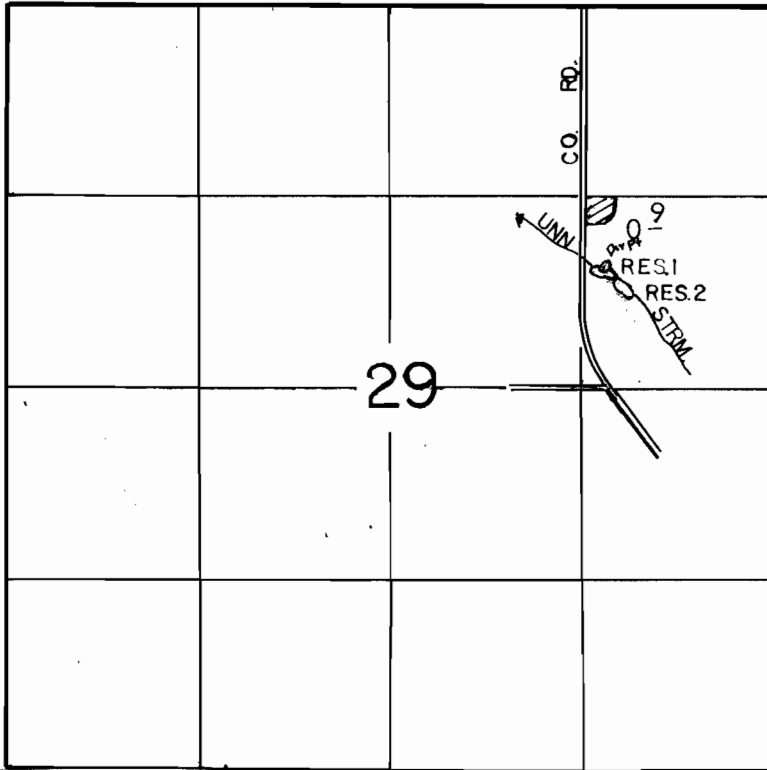

RES. 1 LOC. 1850' S. & 1250' W., RES. 2 LOC. 1900' S. & 1100' W.  
 DIV. PT. LOC. 1800' S. & 1200' W., ALL FROM THE N.E. COR. OF SEC 29

SCALE: 1" = 1320'

## FINAL PROOF SURVEY UNDER

R-57486      R-7673  
 Application No. 57487 Permit No. 43306...  
 IN NAME OF

...WALLACE E. & MONITA JOHNSON

Surveyed JULY 28... 1987... by I.M. WARREN.....