

T. 1 S., R. 4 W., W. M.

Sec. 23

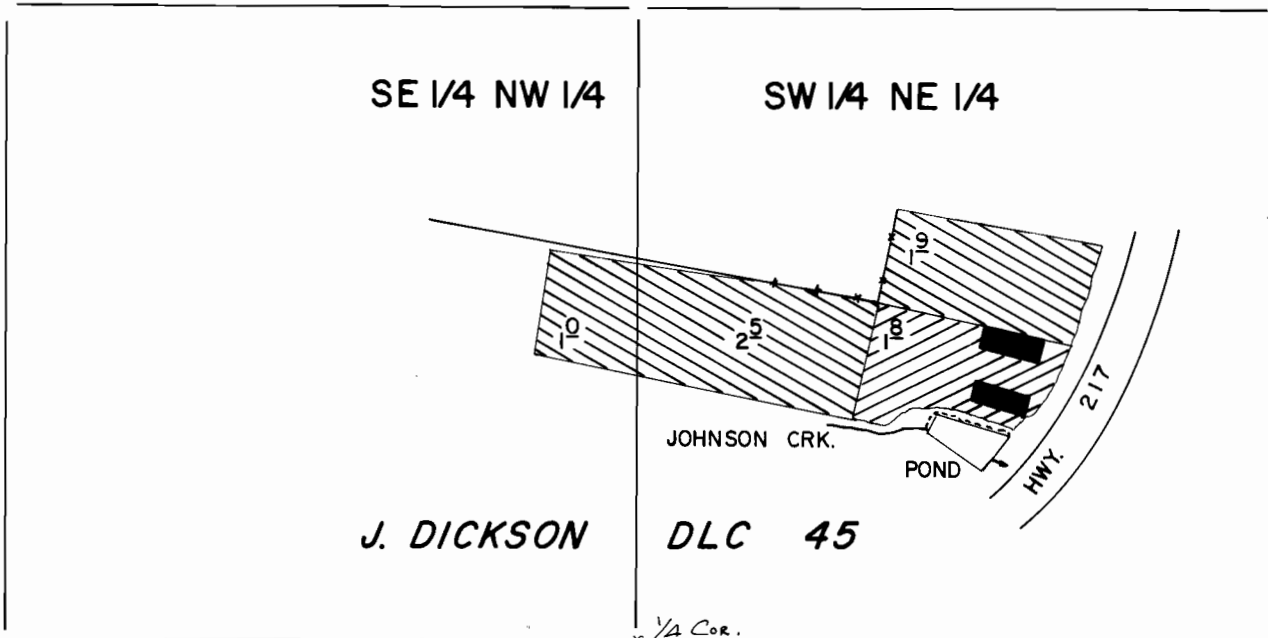

P.O.D. Loc. : 370' N. & 740' from C-1/4 Cor. Sec. 23

 IN-GROUND STOCK

 CONTAINER STOCK

 GREENHOUSE

Scale : 1" = 400'

FINAL PROOF SURVEY UNDER

R-66011 R-8897
Application No. 65194 Permit No. 47890

IN NAME OF

GREG BALLARD

Surveyed JULY 27 1988, by T. WARREN

PTS W/F.F.
12/9/88 T.M.W.