

T. 3S., R. 40E., W.M.

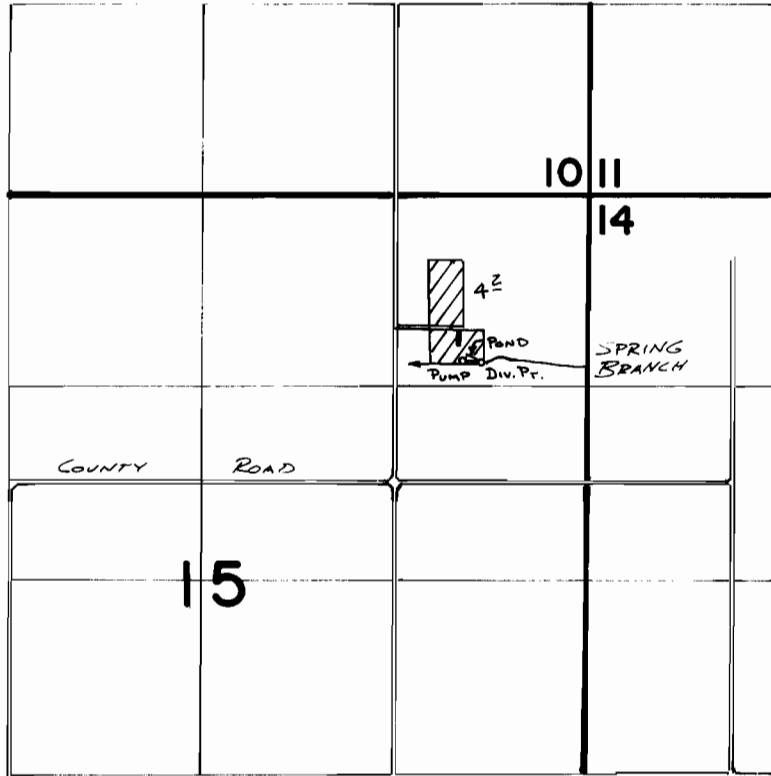

Div. Pt. Loc: 1140'S. & 730'W. FROM NE COR. SEC. 15

FINAL PROOF SURVEY
UNDER

R-62425 **R-8381**
Application No. **62426** Permit No. **46571**....
IN NAME OF

RAY M. & LUELLA KELLOGG

Surveyed 6-8..... 1988, by V.L. Church.....