

RECEIVED

AUG 26 1965

WATER RESOURCES DEPT
SALEM, OREGON

T.1N., R.4W., W.M.

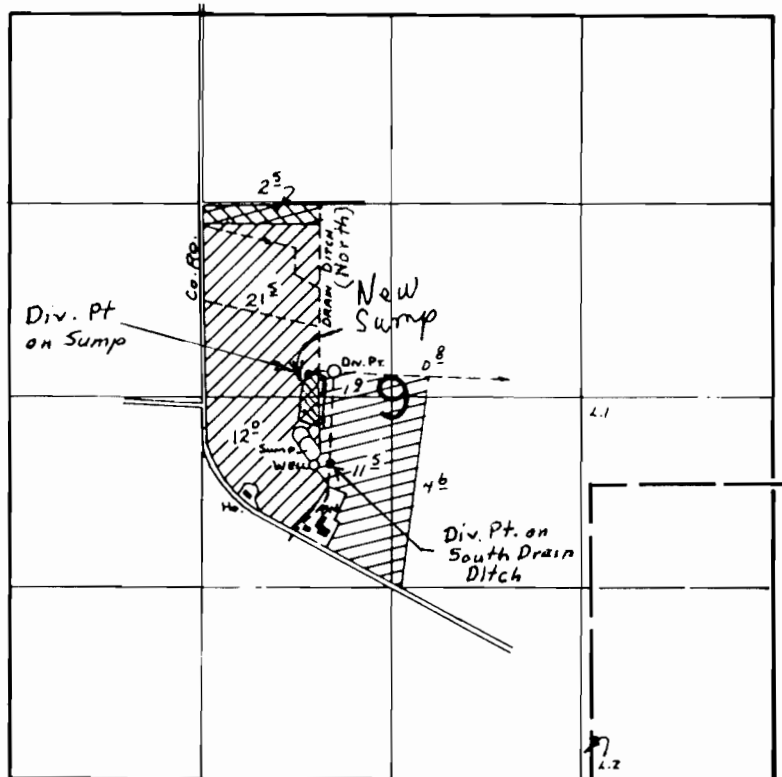

North Drain Dth. Div. Pt.: 1150' S & 920' E.
from the NW corner of SE 1/4 NW 1/4 of Sec. 9

South Drain Dth. Div Pt: 1800' S & 880' E.
from the NW corner of SE 1/4 NW 1/4 of Sec. 9

Sump Div. Pt: 1200' S & 710' E from
the NW corner of SE 1/4 NW 1/4 of Sec. 9

Application No. R-68473 & 68534

Permit No. R10529 49461