

T. 7 S., R. 1 W., W. M.

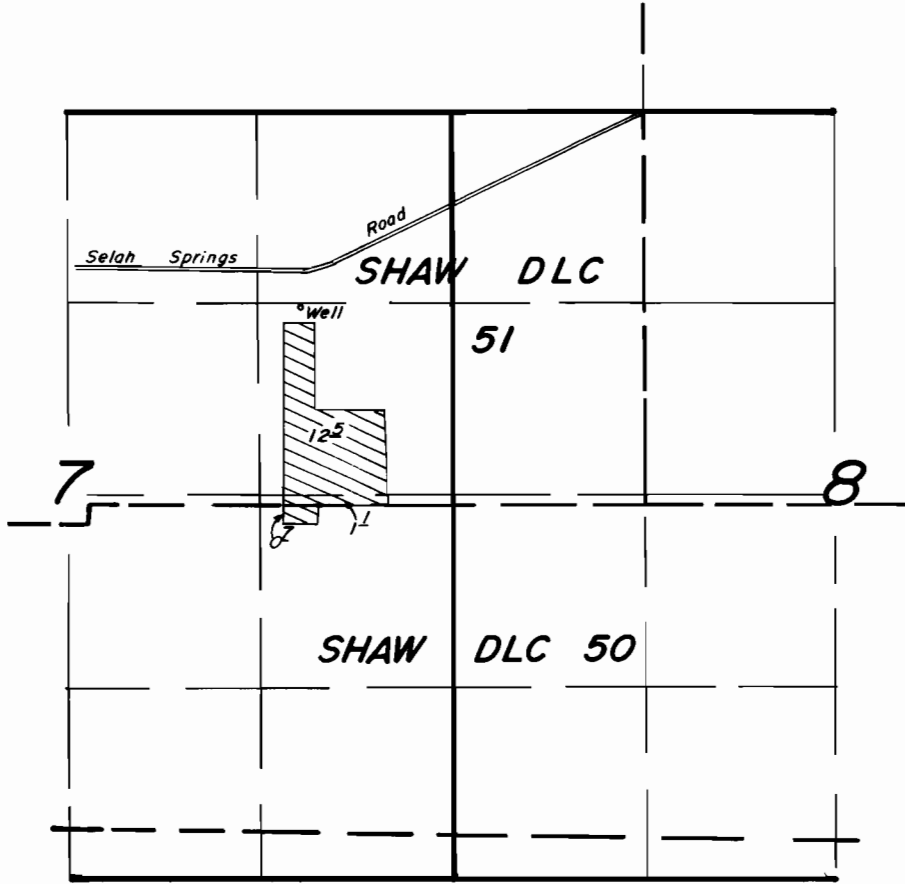

Well Loc.: 1360' N. & 2360' W. from SE Cor. SHAW DLC 51.

Scale: 1" = 1320'
FINAL PROOF SURVEY
UNDER

Application No. ~~G-10064~~ Permit No. ~~G-9152~~.....
IN NAME OF

JIM ULVEN

Surveyed JUNE 6, 1984, by BEN BISHOP.....