

T.8S., R.5&6W., W.M.

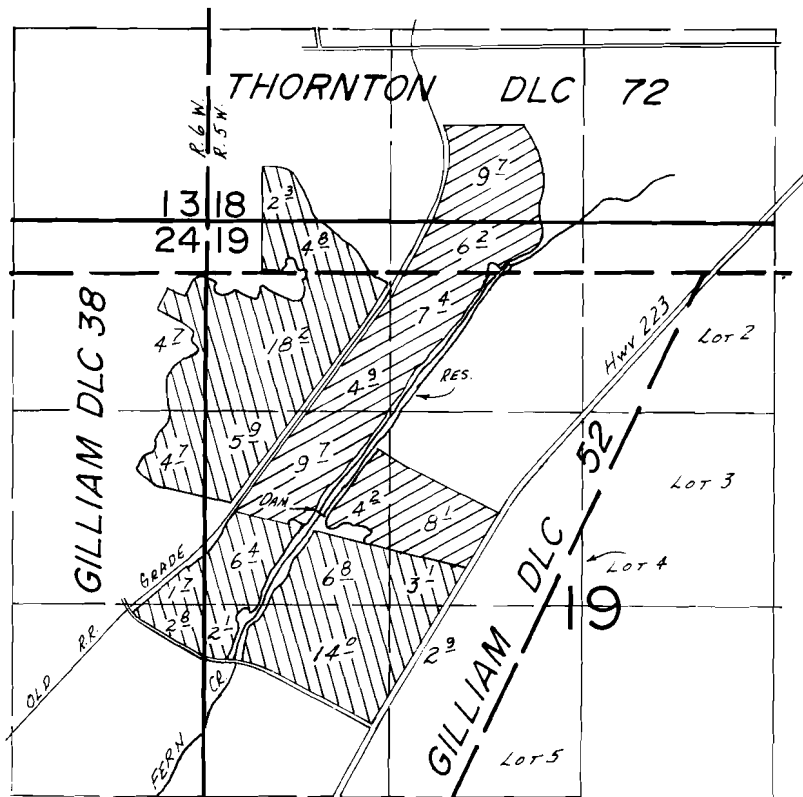

Div. Pt. LOC.: 670' N. & 800' E. FROM N 1/4 COR. SEC. 19.

SCALE: 1" = 1320'

### FINAL PROOF SURVEY UNDER

54419                      40807  
 R-49036                    R-5787  
 Application No. 49037      Permit No. 35828

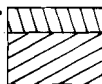

IN NAME OF

.....MR. & MRS. SAM OBERG.....

Surveyed June 10, 1976, by R. G. MUCKEN...  
 Sept. 10 1981                      L. M. TOLL