

T.3S., R.4 & 5 W., W.M.

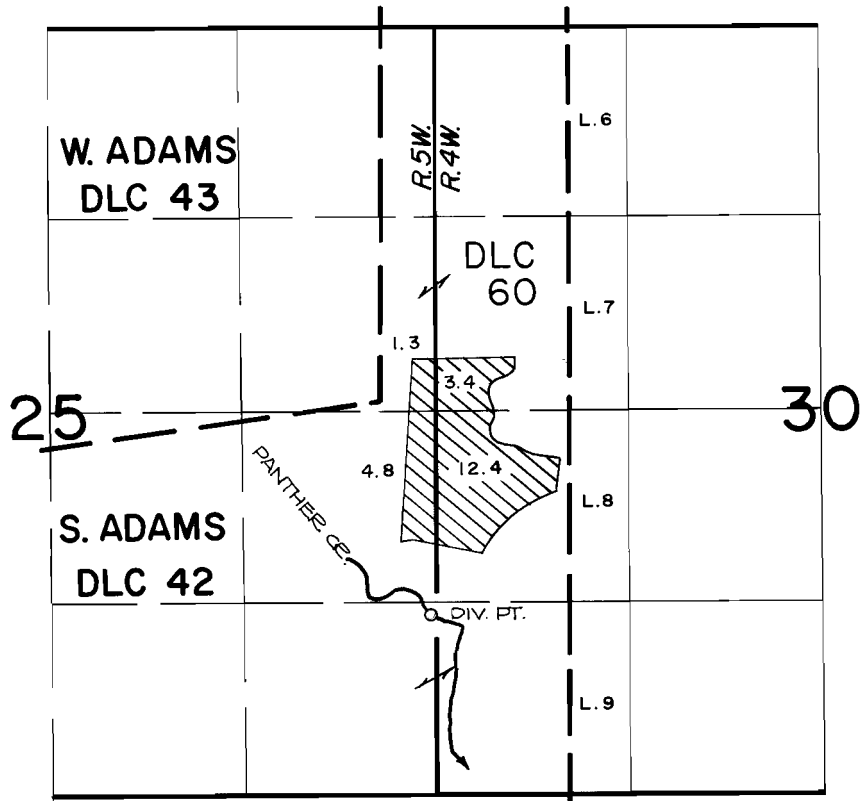

DIV. PT. LOCATION: 1250 FT. N. AND 50 FT. W. FROM THE S.E. CORNER OF SECTION 25.

SCALE: 4" = 1 MILE

**FINAL PROOF SURVEY**  
UNDER

Application No. 57145.. Permit No. 42927.....  
IN NAME OF

..... **LARRY C. COE** .....

Surveyed JULY 11, 1984, by P. Pagter.....