

T.39S. R.3W. W.M.

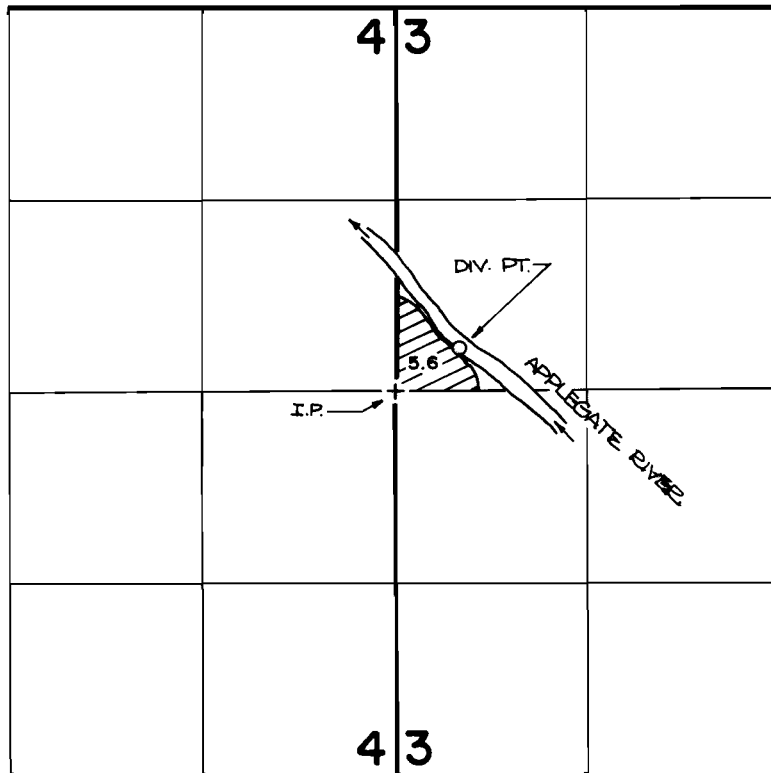

DIVERSION POINT IS LOCATED 280' N. AND 420' E. FROM THE W. 1/4 CORNER OF SECTION 3.

FINAL PROOF SURVEY
UNDER

Application No. **58868** Permit No. **44479..**
IN NAME OF

RICHARD A. AND/OR GAYLE N. LUPTON

Surveyed **MAY..19.. 1983**, by **..B..JAMES.....**