

T. 2N., R. 33E., W.M.

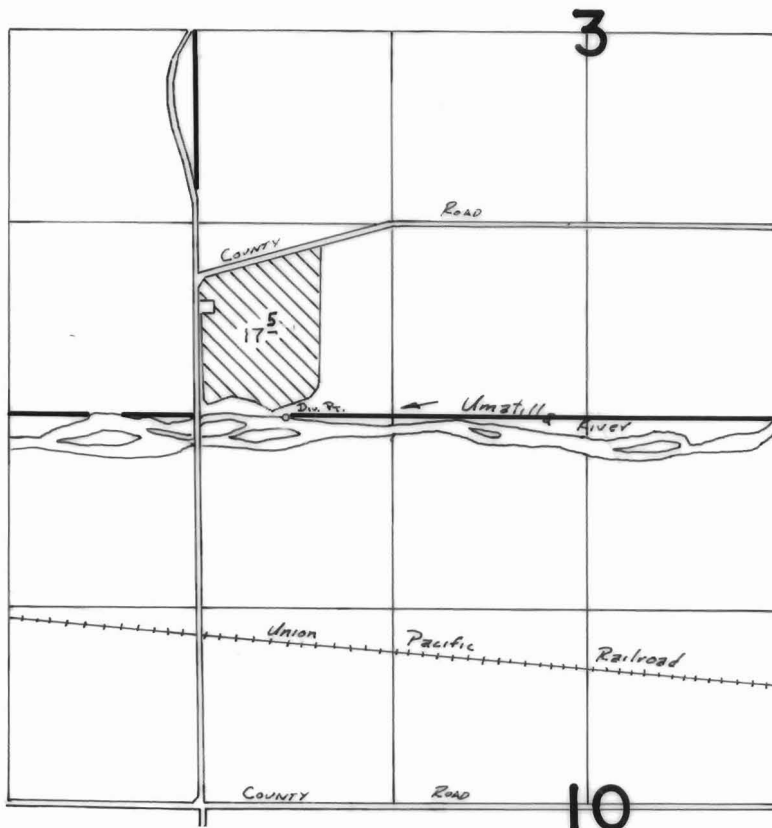

SCALE: 1" = 1320'

Div. Pt. LOCATED 10' N. & 600' E. FROM NW COR. SEC. 10

### FINAL PROOF SURVEY UNDER

Application No. **59480** Permit No. **44747**....  
IN NAME OF

.....**WILLIAM R. DUFF**.....

Surveyed *May 10*.... 1984., by *V. h. Skwosh*.....