

T.19S. R.42E. W.M.

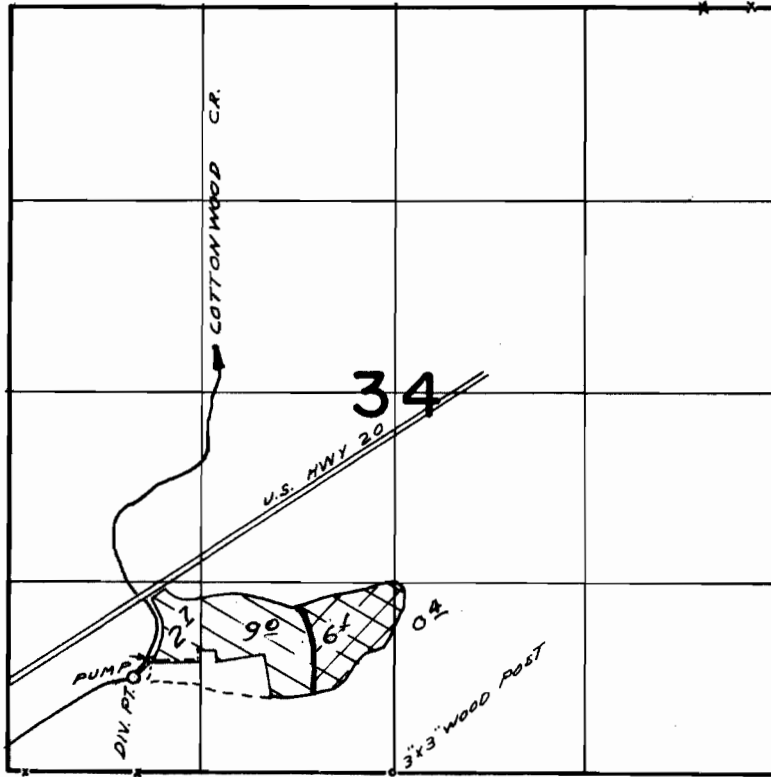

DIV. PT. LOC. 640' N. & 1770' W. FROM S 1/4 COR., SEC. 34

Primary 
Supplemental 

FINAL PROOF SURVEY UNDER

Application No. 40386... Permit No. 30363...
IN NAME OF



..... CARL A. Bevans

Surveyed AUG. 25, 1973, by L.E. GOULD
MAY 9, 1975, L.H. NUNN

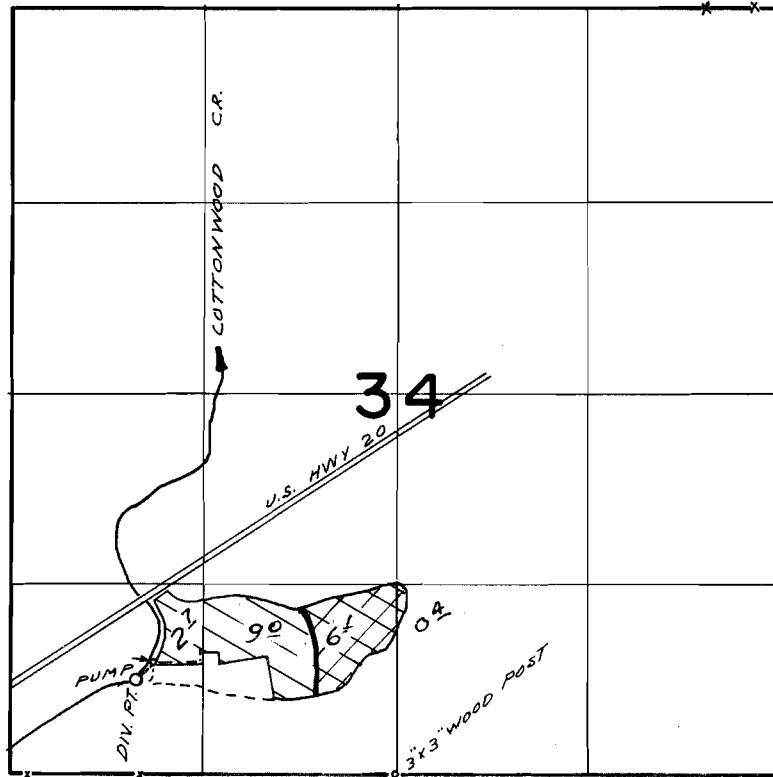
T.19S. R.42E. W.M.



DIV. PT. LOC. 640' N. & 1770' W. FROM S 1/4 COR., SEC. 34

Primary 
Supplemental 

FINAL PROOF SURVEY UNDER

Application No. 40386... Permit No. 30363...
IN NAME OF

..... CARL A. Bevans

Surveyed AUG. 25. 1973. by L.E. GOULD.....
MAY 9 1975 L.H. NUNN