

T.25S., R.5W., W.M.
SECTIONS 5, 6, 7, & 8

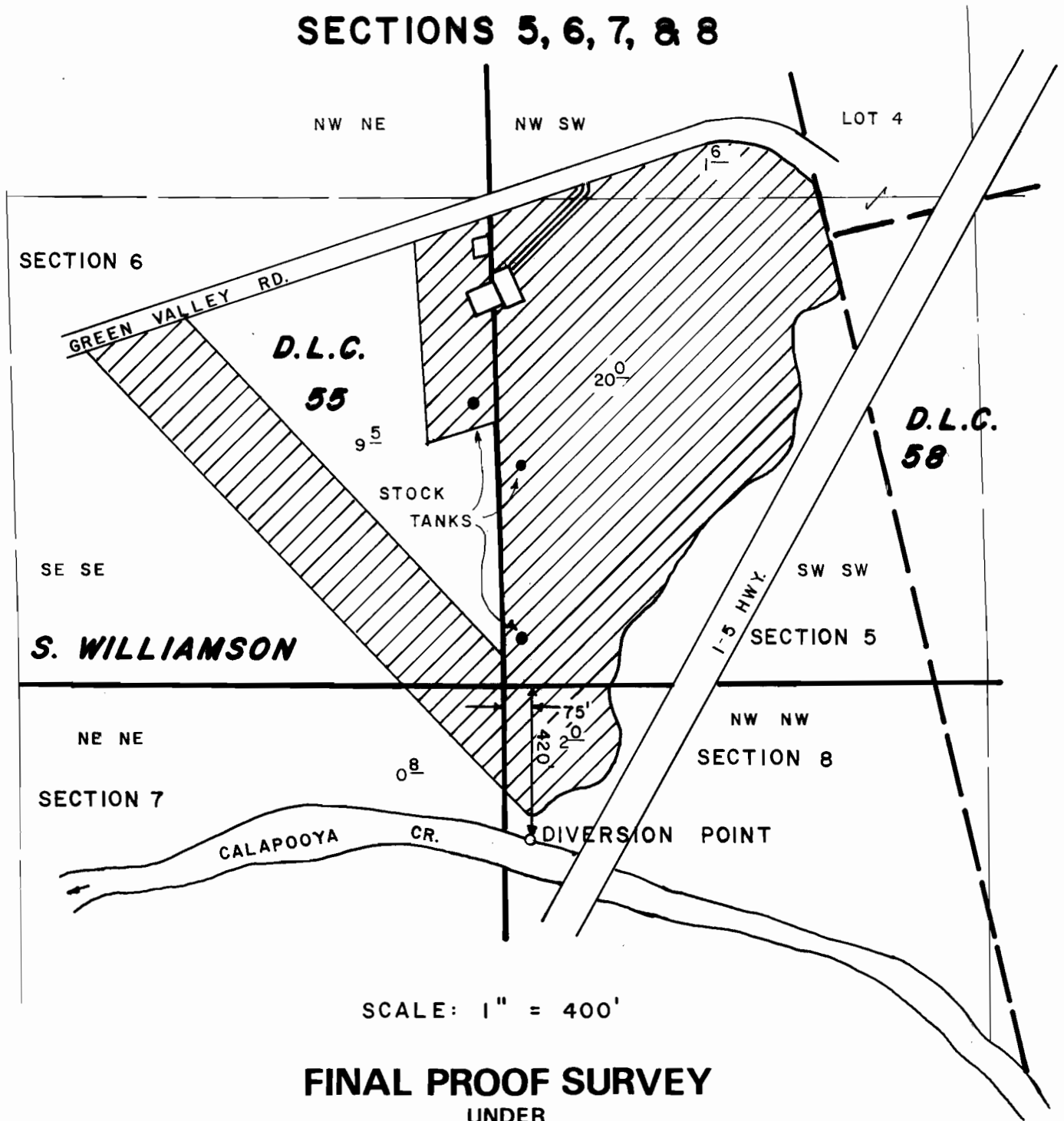

SCALE: 1" = 400'

FINAL PROOF SURVEY
UNDER

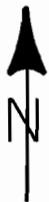

Application No. 64067 Permit No. 47104
IN NAME OF

KENNETH L. and JUILA A. GREEN

Surveyed JULY 1, 1986, by J. M. SCHMORDE