

T. 4N., R. 29E., W.M.

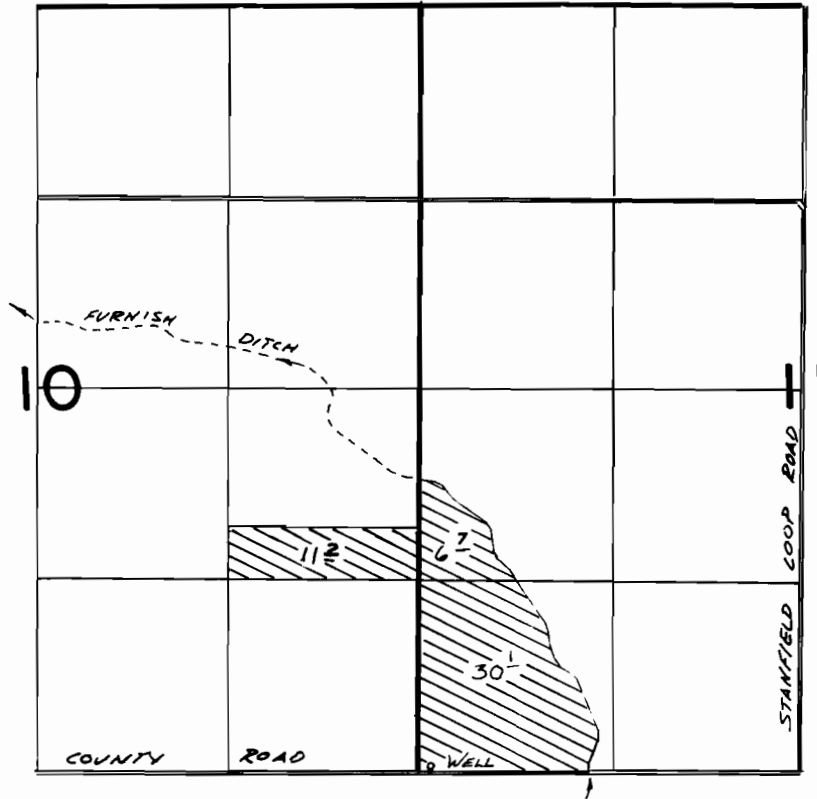

WELL LOC: 40' N. & 80' E FROM SW COR. SEC 11

**FINAL PROOF SURVEY**  
UNDER

Application No. **G:10128** Permit No. **G:9307**  
IN NAME OF

**IVAN J. COOK**

Surveyed Dec. 7 1982, by V. H. Church