

T. 3N., R. 27 & 28E., W. M.

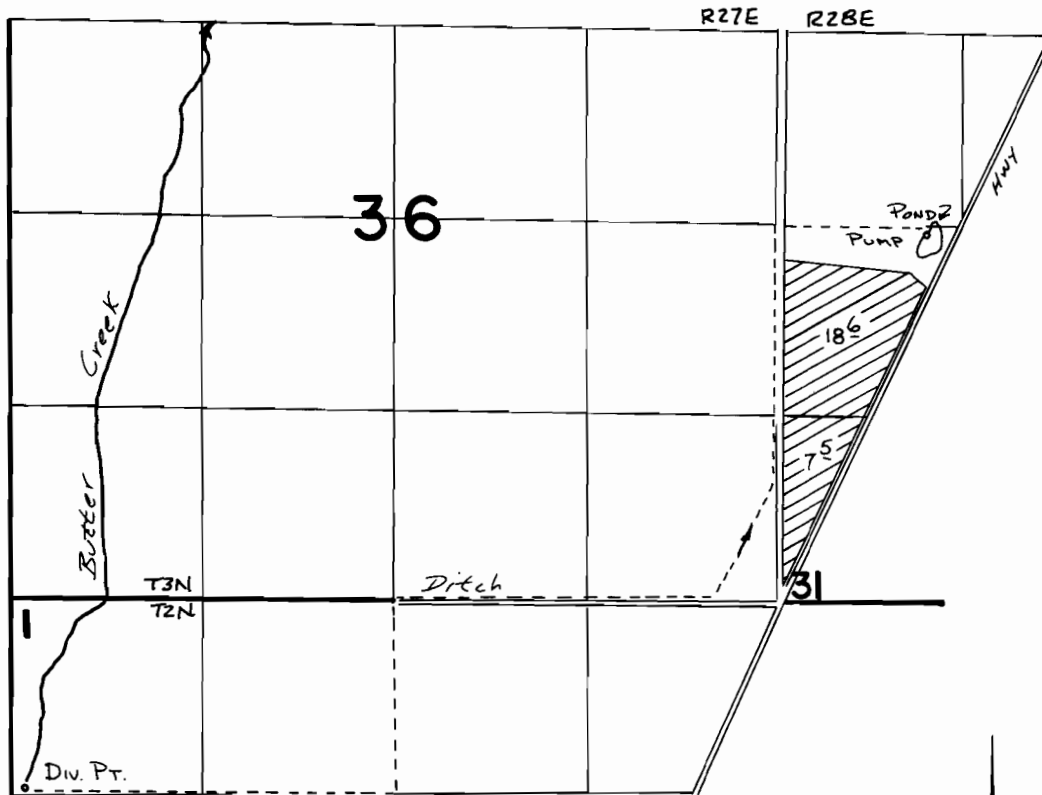

Div. Pt. LOCATED 1320'S. & 90'E. FROM NW COR SEC 1

**FINAL PROOF SURVEY**  
UNDER

Application No. **54880** Permit No. **41446**.....  
IN NAME OF

.....**LOWELL R. SAYLOR**.....

Surveyed **2-22**..... 19**77**., by **P. Barwin**.....

SCALE: 1" = 1320'

