

T.6S., R.7W., W.M.

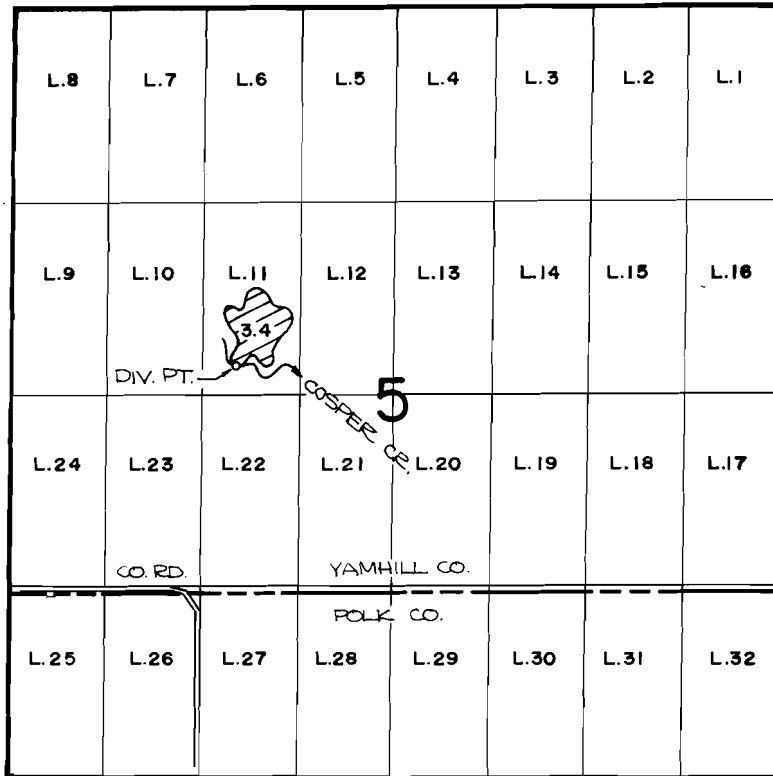

DIV. PT. LOCATION: 1120 FT. S. AND 230 FT. E. FROM THE N.W. CORNER OF LOT 11.

FINAL PROOF SURVEY UNDER

Application No. 58892... Permit No. 44461.....
IN NAME OF

.....CRAIG A. TRITTEN.....

Surveyed NOV. 16, ... 1984., by *P. Pagten*.....



SCALE: 4" = 1 MILE