

T.17S. R.8W. WM.

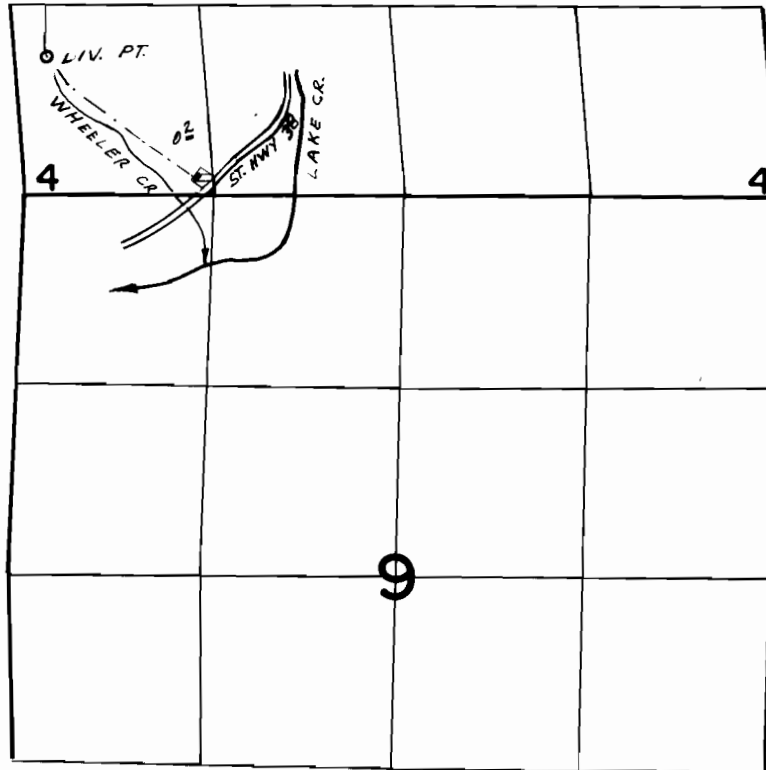

DIV. PT. LOC. 950' N. $\frac{1}{2}$ 15" E. FROM SW COR. SEC. 4

FINAL PROOF SURVEY
UNDER

Application No. 42823 Permit No. 31590
IN NAME OF

JOHN BEAMAN

Surveyed MAY 4 1976, by L.H. NUNN