

33307
61785

T. 35S., R. 7E., W.M.

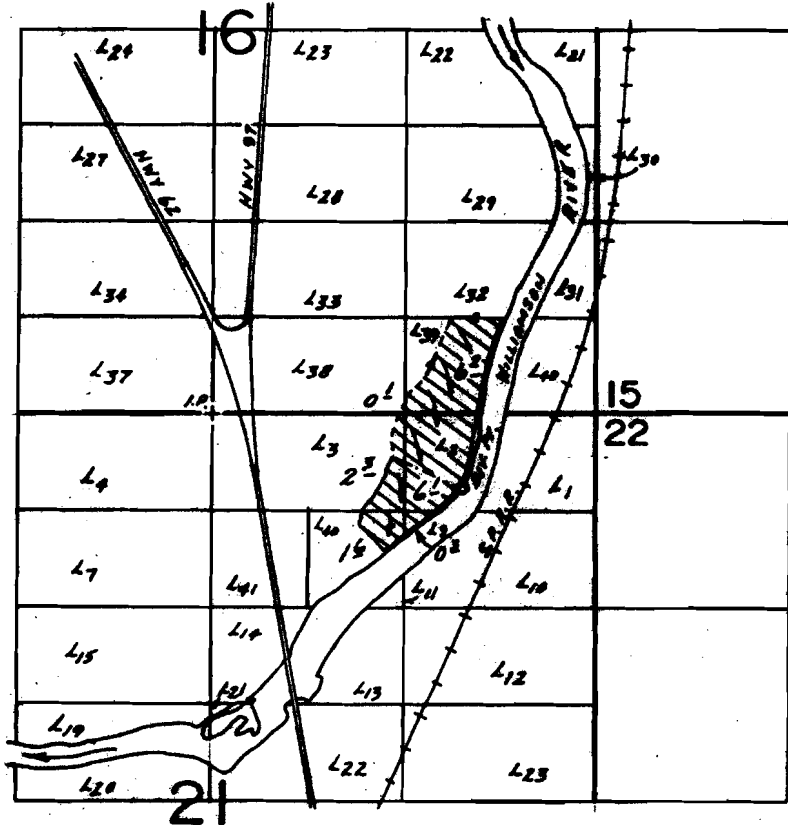

Div. Pr. Loc.: 500'S. & 1710'E. FROM N. 1/4 COR. SEC. 21

SCALE: 1"=1320'

FINAL PROOF SURVEY
UNDER

Application No. 44505.. Permit No. 33307.....
IN NAME OF

GIENGER ENTERPRISES, INC.....

Surveyed Sept. 15.. 19.86, by B.W. BISHOP.....

1-20-87
CNO-111-126