

T.17S.R.3W.W.M.

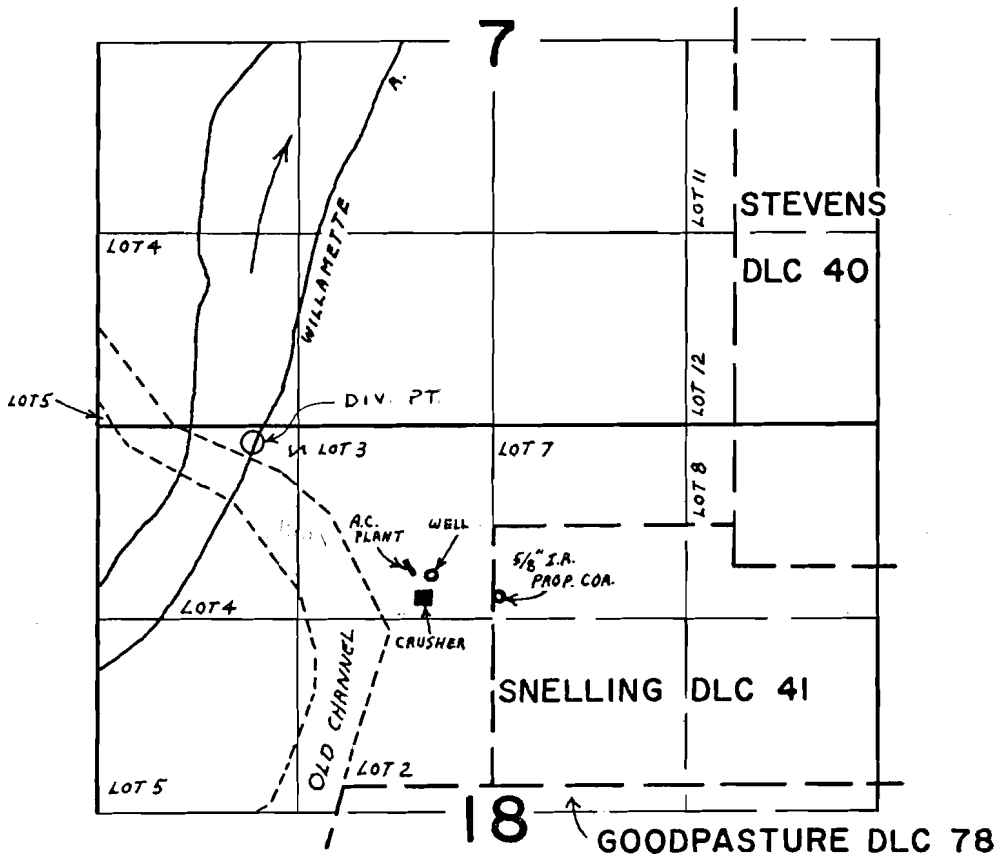

~~WELL LOC. 330' S. & 430' W. FROM NW COR. SNELLING DLC 41~~
 Div Pt. Loc: 590' N & 1630' W fr. NW Cor. Snelling DLC 41

FINAL PROOF SURVEY

UNDER

Application No: ~~53409~~ ³⁸⁰⁷¹ Permit No. ~~6-3792~~ ⁶⁻³⁵⁷⁴

IN NAME OF

EUGENE SAND & GRAVEL, INC.

Surveyed ~~Sept. 12~~ ⁷⁹ ~~1970~~ by ~~G. BAGA~~ ^{C.L. Hughes}