

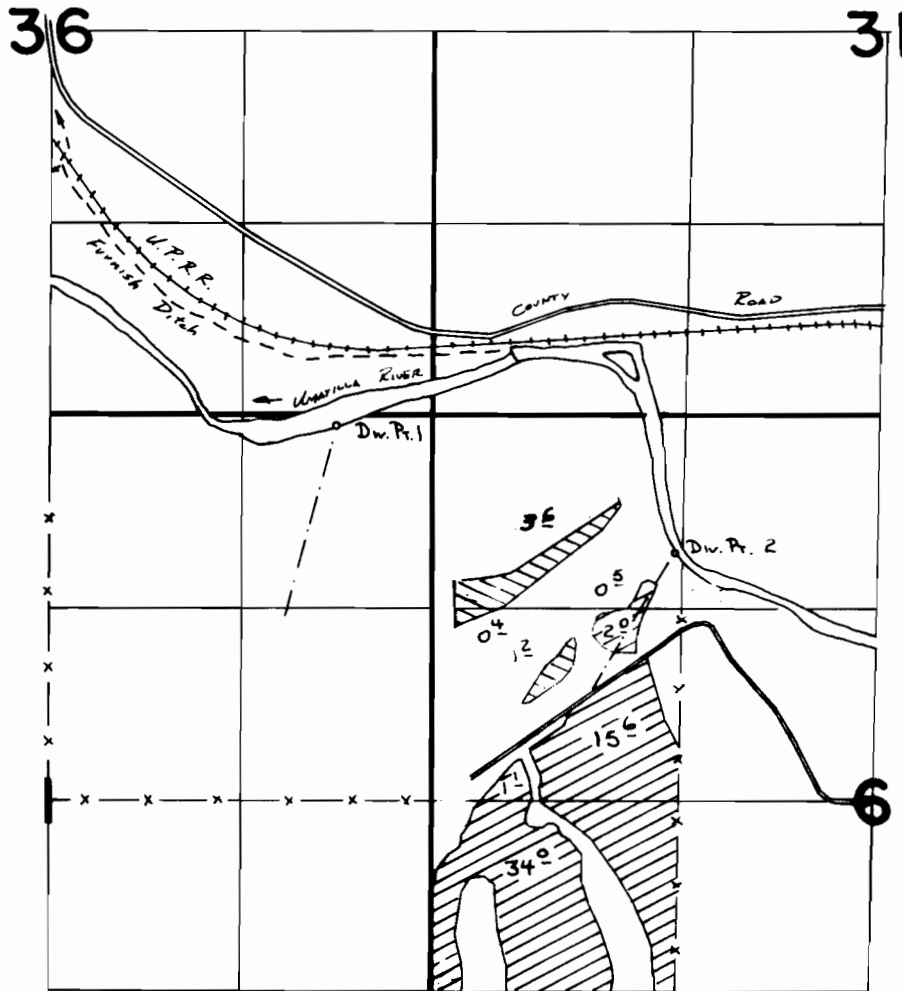

T. 2N., R. 29&30E., W.M.



Div. Pt. 1 LOCATED 70'S. & 650' W. FROM NE COR. SEC. 1

Div. Pt. 2 LOCATED 950'S. & 1660'E. FROM NW COR. SEC 6

FINAL PROOF SURVEY UNDER

 Div. Pt. 1

 Div. Pt. 2

Application No. **53629** Permit No. **401.18**.....
IN NAME OF

.....**HERBERT C. BORK**.....

Surveyed Oct. 3, 1984, by V. L. Church.....