

T. 26 S., R. 6 W., W.M.

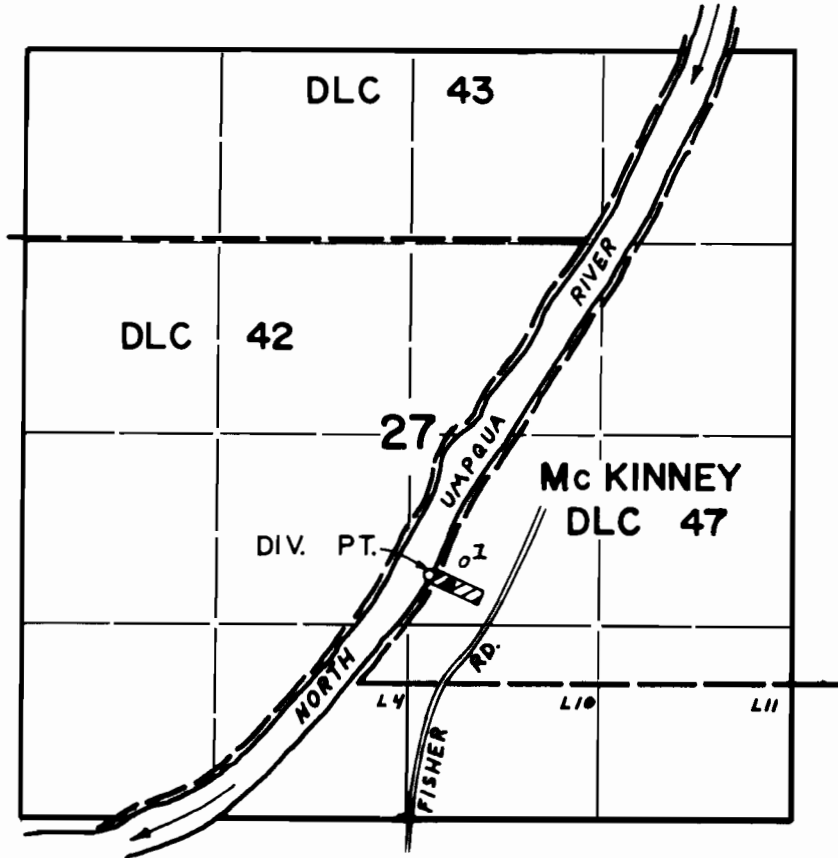

DIV. PT. IS 1670' N. AND 150' E. OF THE
S. 1/4 CORNER OF SEC. 27

SCALE: 4" = 1 mile

FINAL PROOF SURVEY
UNDER

Application No. 60631 Permit No. 45392.....
IN NAME OF

RICHARD E. MOREHEAD

Surveyed NOV. 18, 1983, by *L. E. Cashion*