

G9825
61843

T.4N. R.29E., W.M.

N

SCALE 1" = 1320'

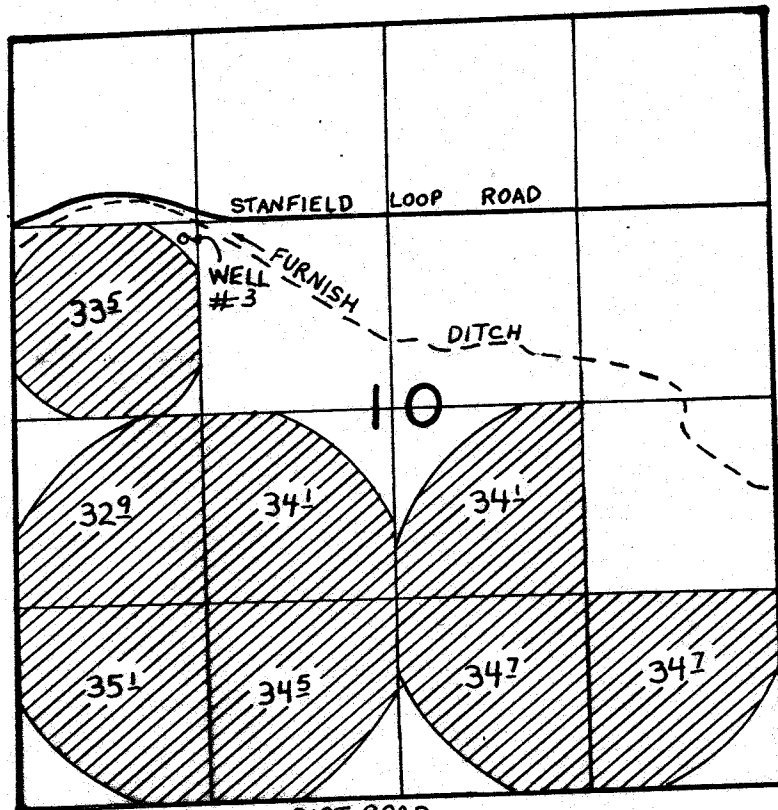

DIRT ROAD
WELL LOCATION: 1420' W + 1200' N CENTER OF SECTION

FINAL PROOF SURVEY UNDER

Application No. G-10758 Permit No. G 9825
IN NAME OF

H.T. BURNS, INC.

Surveyed June 10 1986, by V. Church