

G 9106  
61871

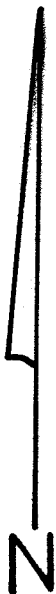

# T. 1 N. R. 32 E. W. M.

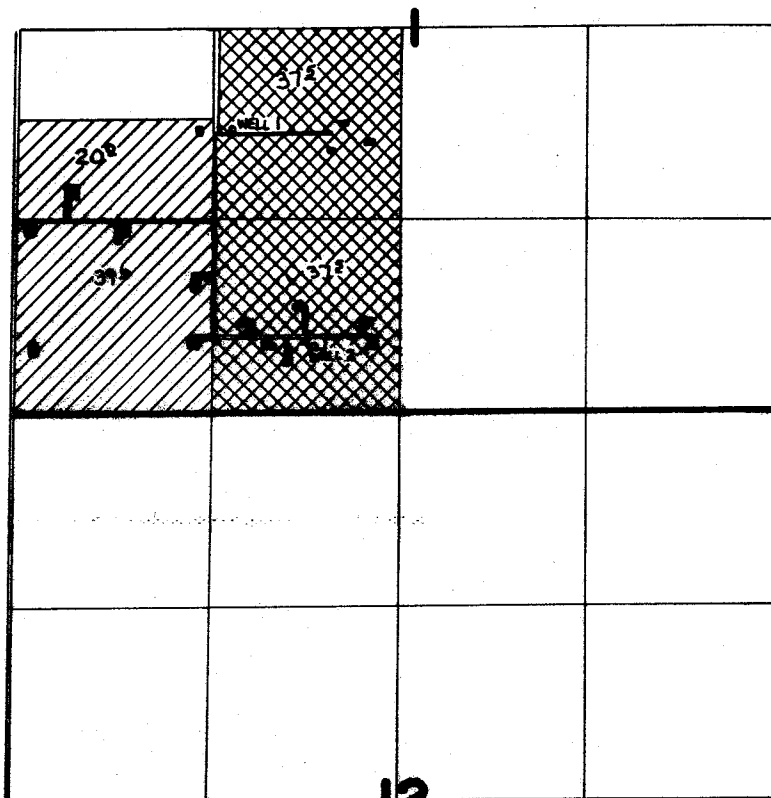

Scale 1" = 1320'



WELL 1 LOC. 700' S & 1160' W. FROM CENTER SEC. 1  
 WELL 2 LOC. 2160' S & 600' W. FROM CENTER SEC. 1

 PRIMARY       SUPPLEMENTAL

## FINAL PROOF SURVEY UNDER

Application No. G.6804. Permit No. G.9106.....  
 IN NAME OF

**McKAY ACRES IMPROVEMENT DIST.**

Surveyed Feb. 27, 1986, by V. Church.....