

T. 6 S., R. 1 W., W.M.

22

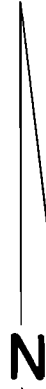
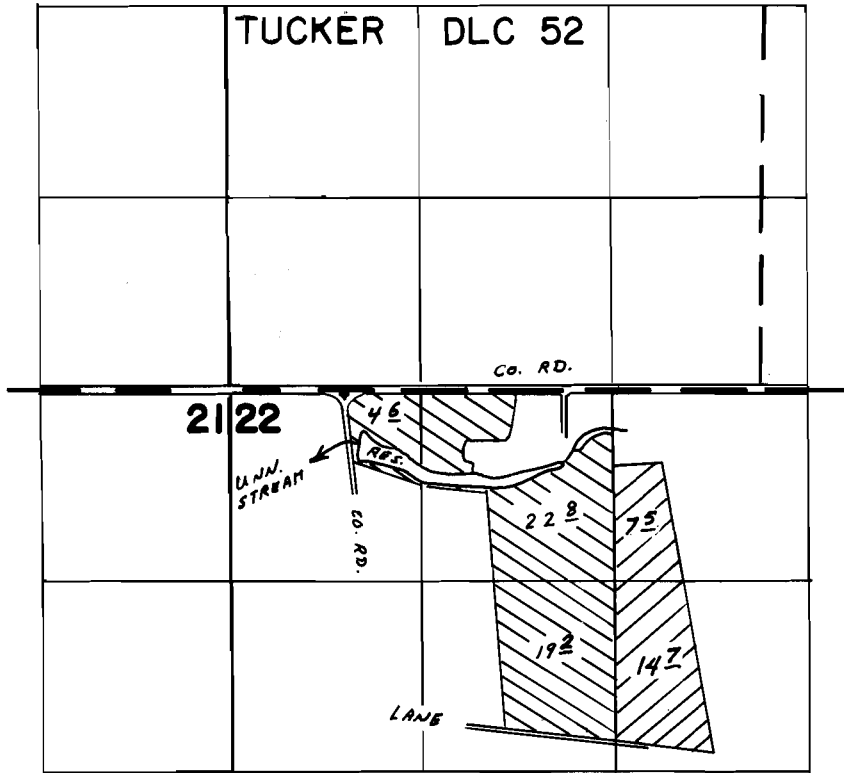
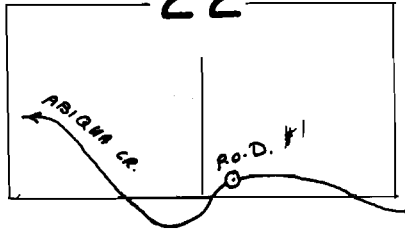

ABIQUA CREEK DIV 1230' S AND 200' E FROM C/4 SEC. 22
 UNN. STR AND RESERVOIR: 360' S AND 860' E FROM NW CORNER SEC 22

 PRIMARY

 SUPPLEMENTAL

SCALE 1" = 1320'

FINAL PROOF SURVEY
 UNDER

Application No. 61943 Permit No. 46542
 IN NAME OF

DENNIS SCHIEDLER

Surveyed MAY 18 1988, by Z. SALEH

41047-278-129 B

1-23-89 Z.F.S.