

T. 3 S., R. 1 W., W.M.

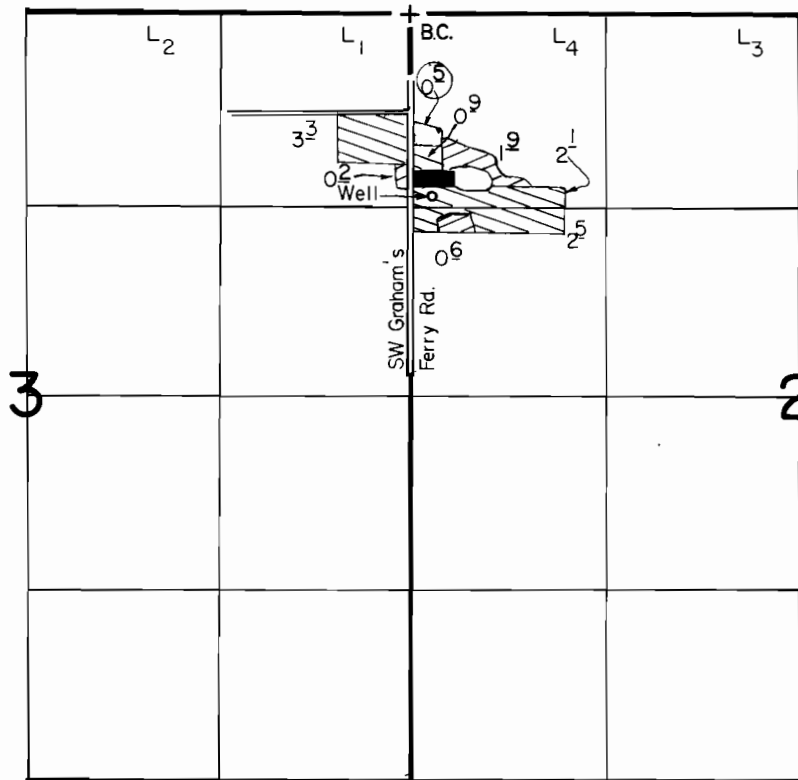

-  IN-GROUND STOCK (SUPPLEMENTAL)
-  CONTAINERS
-  GREENHOUSE

Well Loc. : 1250' S. & 150' E. from NW Cor., Sec. 2.

Scale : 1" = 1320'

FINAL PROOF SURVEY UNDER

Application No. G-7872... Permit No. G-9887.....
IN NAME OF

LINDA RUMGAY

Surveyed JULY 22, 1987, by T. Warren