

T. 36 S., R. 3 W., W. M.

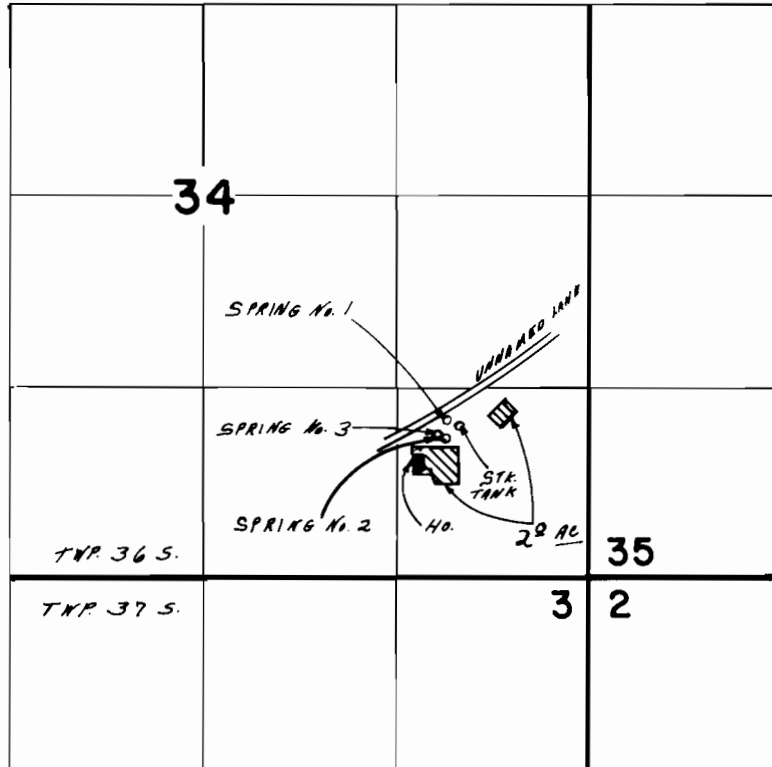

SPRING LOCATIONS:

- (1) 1090' N., 960' W.;
- (2) 950' N., 980' W.;
- (3) 980' N., 1040' W.;

ALL FROM SE COR. SEC. 34

Scale: 1" = 1320'

FINAL PROOF SURVEY UNDER

Application No. **49326** Permit No. **36979**
IN NAME OF

JERRY DEAN COE

Surveyed JUN. 26. 19.86, by B. S. JAMES.