

T. 10 S., R. 6 W., W.M.

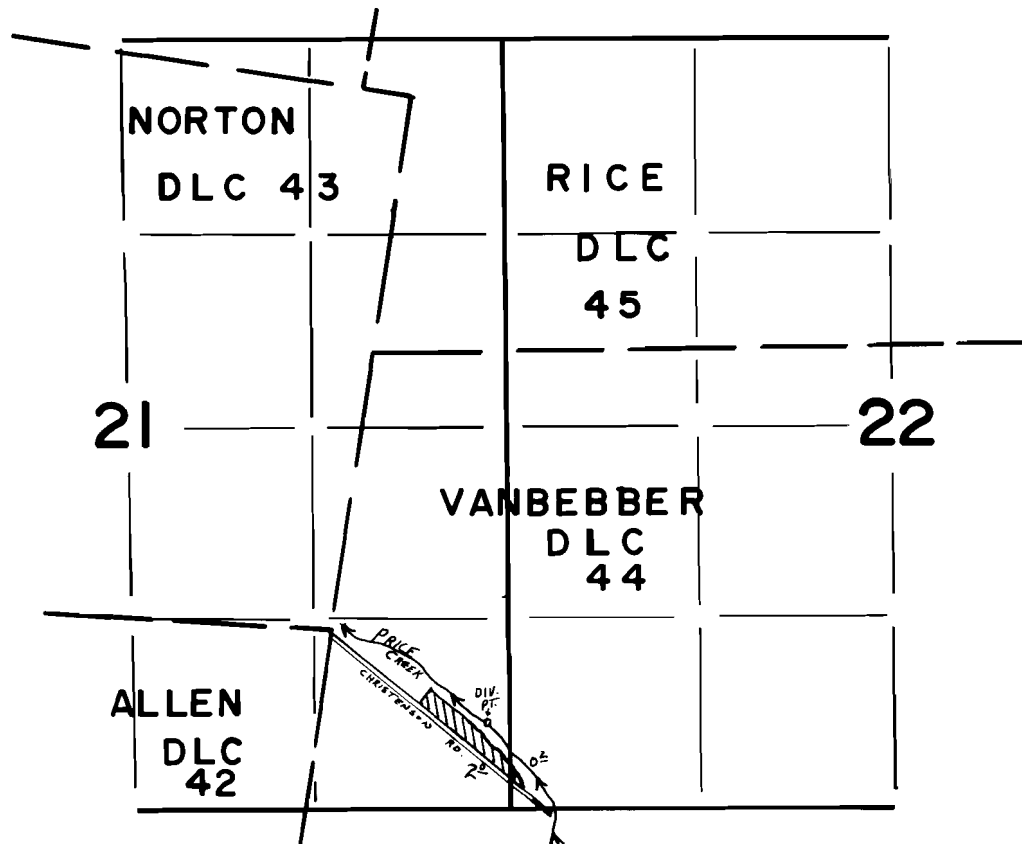

DIV. PT. LOC.: 660' S. & 1060' E. from SE Cor.  
NORTON DLC 43

**FINAL PROOF SURVEY**  
UNDER

Application No. 604.4.5. Permit No. 45036.....  
IN NAME OF

.....DONALD J. BREWER.....

Surveyed JUNE 13, 1983, by L. TOLL.....