

T.6S., R.1E., W.M.

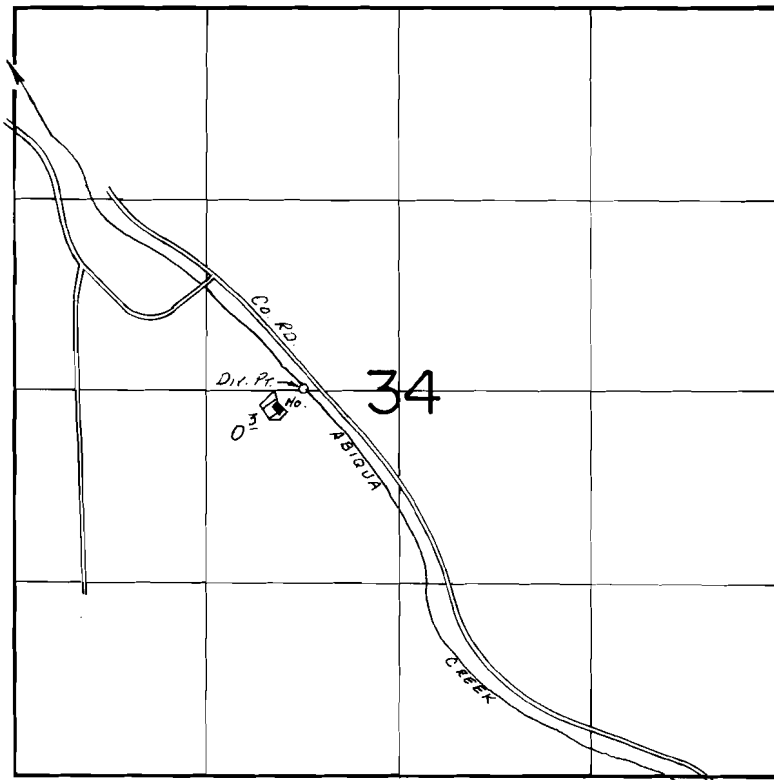

Div. Pt. Loc.: 2620 S. & 2000 E. FROM NW COR. SEC. 34.

SCALE: 1" = 1320'

**FINAL PROOF SURVEY**  
UNDER

Application No. 60485. Permit No. 45196.....  
IN NAME OF

.....LOIS M. WILSON.....

Surveyed June 13, 1984, by B.W. BISHOP.....