

# T. 12 & 13 S., R. 5 W., W.M.

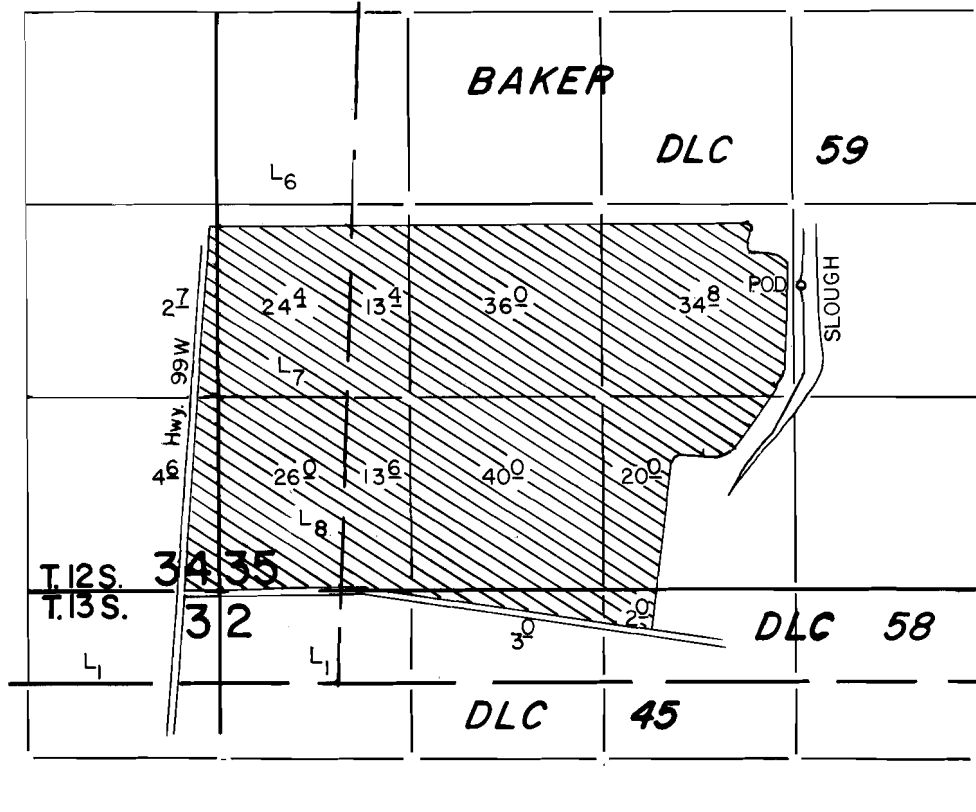

P.O.D. Loc.: 2060' N. & 1260' W. from SE Cor. Sec. 35.

Scale: 1" = 1320'

## FINAL PROOF SURVEY UNDER

Application No. 63691 Permit No. 46879  
IN NAME OF

EDITH E. MILLER & GALE & DIANE MILLER

Surveyed AUG. 3 1988, by T. Warren