

T. 1 S. R. 13 E. W.M.

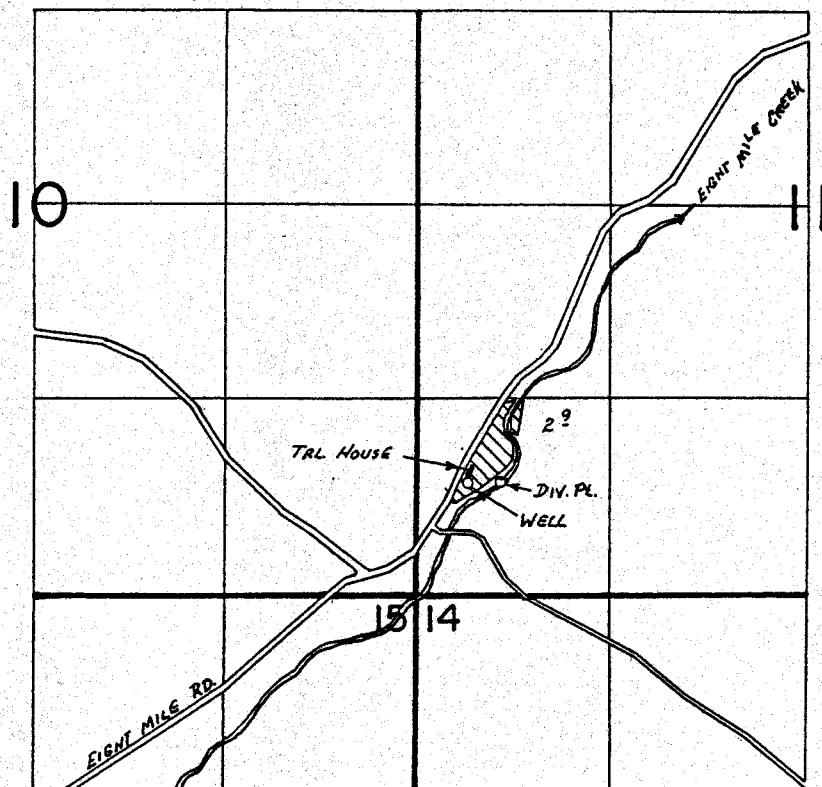

WELL LOC. 760' N & 350' E ; CREEK DIV. LOC. 760' N & 580' E. BOTH FROM THE SW COR. SEC. 11

**FINAL PROOF SURVEY**  
UNDER

G-10452                      G-9527  
Application No. 61908... Permit No. 46303...  
IN NAME OF

.....KENNETH L. FALK.....

Surveyed Oct. 15, 1984, by T. Paul.....